

The idle roller conveyors curves can be realized with cylindrical roller double, axis wheels, roller bearings.

On the left is shown the diagram for the construction of a roller conveyor curve crowds to 90 degrees.

The length of the rollers should be determined based on the width and length of the transported material.

The radius of a curve is measured on the inner side.

$$A = \sqrt{(R+X)^2 + (Y/2)^2} - R + 60$$

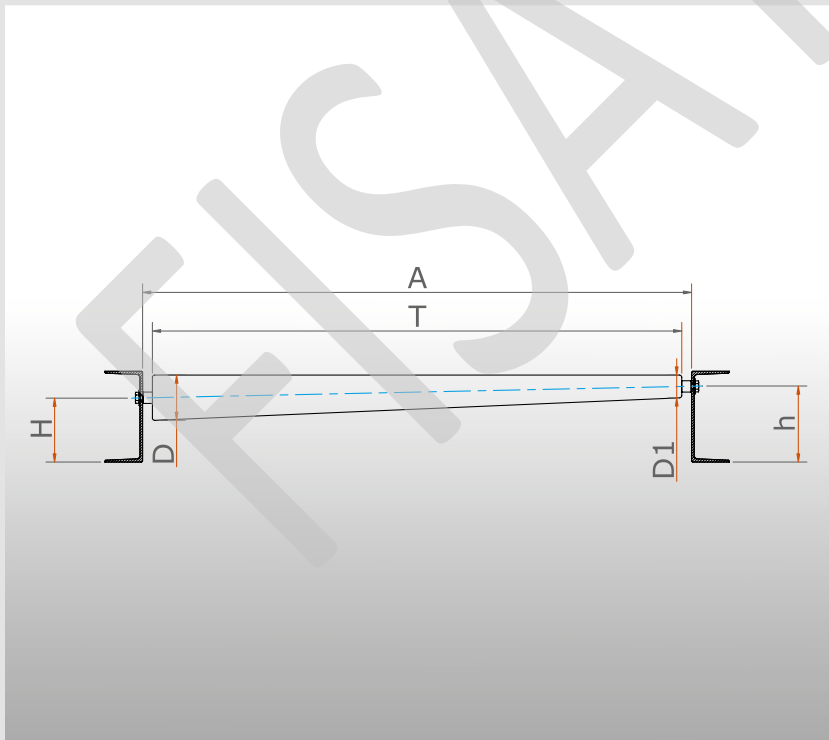

The diagram and the table below show you the correct positioning of the rollers.

$$h = H + \left(\frac{D - D1}{2} \times \frac{A}{T} \right)$$

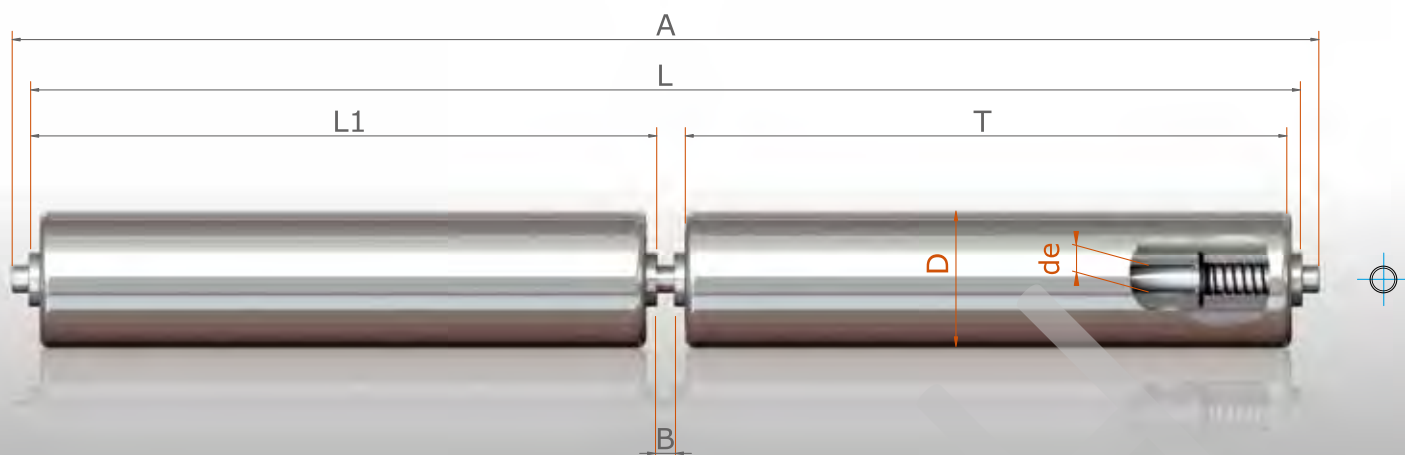

LDP IDLER ROLLERS

CODE	D	de	L1	T	A	B	L MIN	L MAX	WEIGHT L =200	BY CM
L2408DP	24	8	L/2-3	L1-6	L+16	6	300	1000	0,377	0,011
L3008DP	30			L1-7						
L4008DP	40			L1-8						
L5008DP	50	10	L/2-3	L1-4	L+20	6	300	1200	0,870	0,022
L3210DP	32			L1-8						
L5010DP	50			L1-4						
L3212DP	32	12	L/2-3	L1-4	L+20	6	300	1200	0,621	0,017
L5012DP	50			L1-8						

PRODUCT DESCRIPTION

Roller built on the L base series. They are composed of one roller with a spring-lengthened shaft and one idler roller without shaft. They are indicated for idler curves operating by gravity.

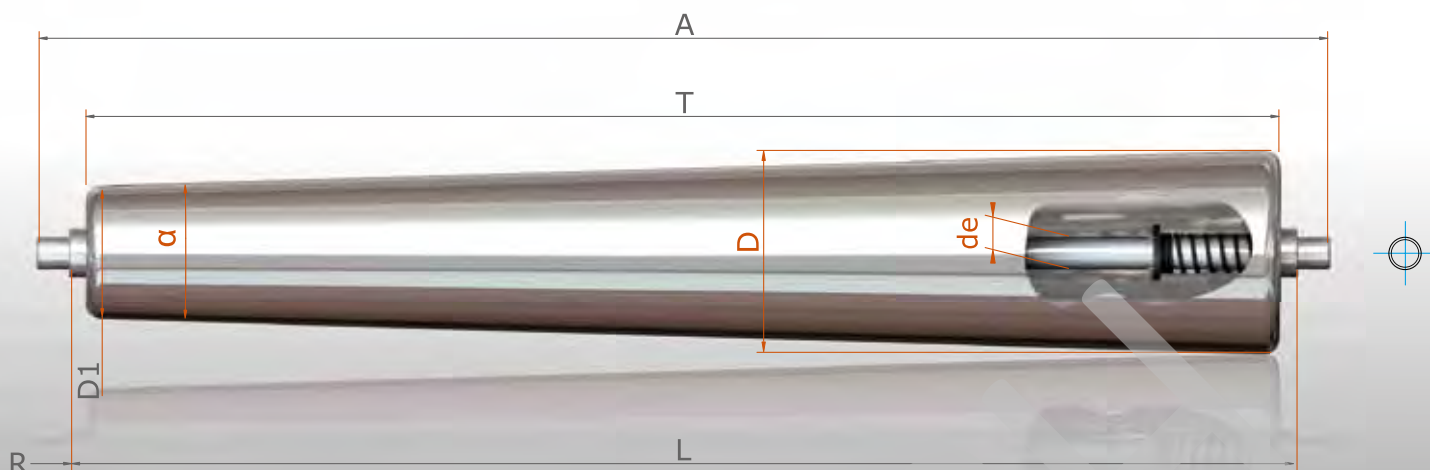

LCF TAPER IDLER ROLLERS

CODE	D	D1	d	A	L	T	R	α	WEIGHT	
LCF4007	50	25	7	416	A-16	A-24	400	3,58	0,93	
LCF4008			8						0,96	
LCF5507		32,5	7	316			550		3,44	0,72
LCF5508			8							0,75

PRODUCT DESCRIPTION

Roller built on the L base series.
 They are used in idler curves with light loads or reduced size for conveying packs with small dimensions.

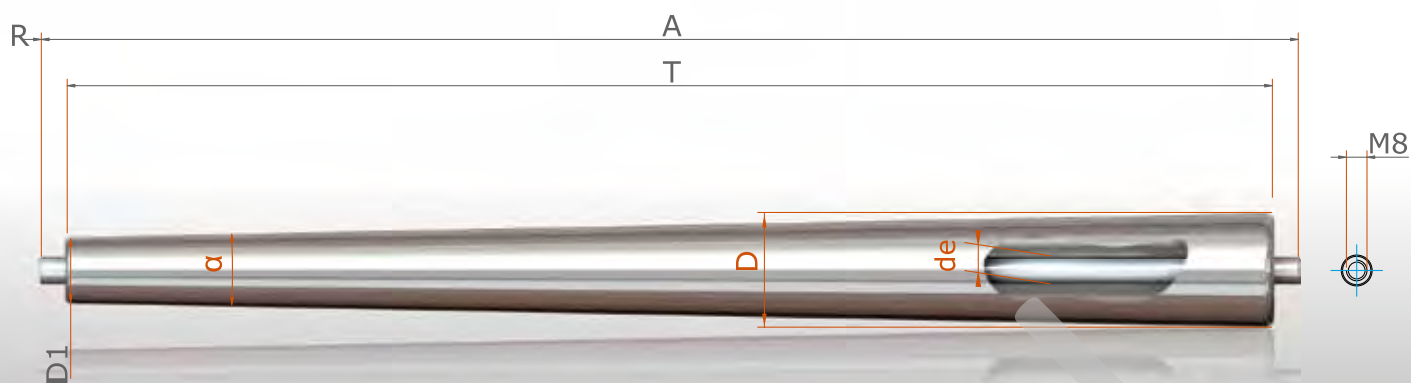

MCF TAPER IDLER ROLLERS

CODE	D	D1	de	A	T	R	α	WEIGHT
MCF80012	60	31,5	12	750	A-26	800	2,26	2,46
MCF90012		35	15	660		900		2,11
MCF90015						900		2,44
MCF100012		30,5	12	1000		1000	1,74	3,79
MCF110012		33,5	15	900		1100		3,42
MCF110015								3,87
MCF120012		35	12	880		1200		1,63
MCF120015							3,47	
MCF130012		38,5	12	750		1300	1,7	2,78
MCF130015								3,15

PRODUCT DESCRIPTION

Roller built on the M base series.
They are used in idler curves with medium loads that are voluminous in size.

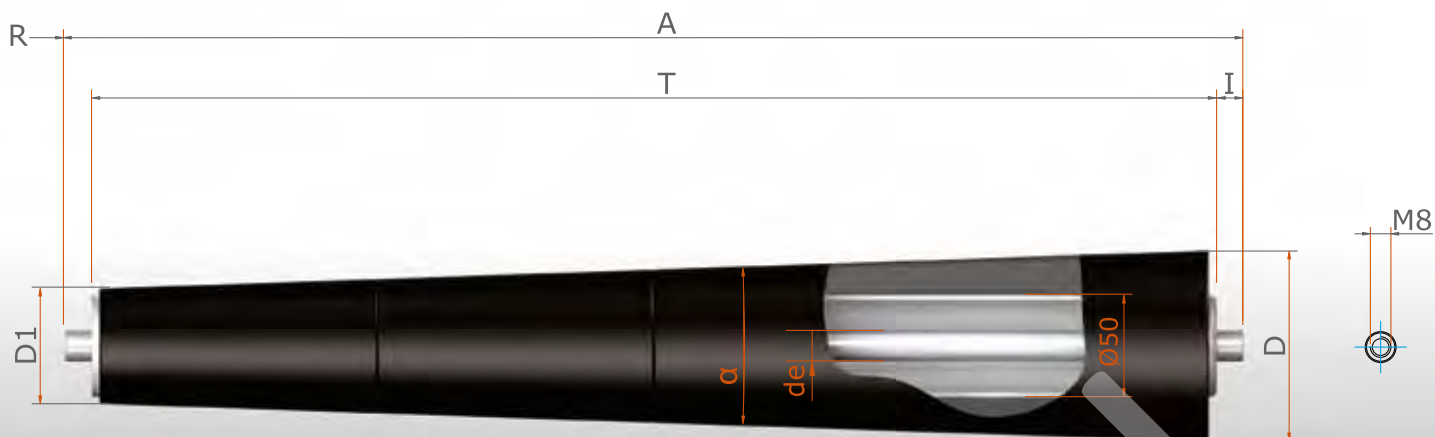

MCFS TAPER IDLER ROLLERS

CODE	D	D1	R	de	I	α	T	A	WEIGHT
MCFS274	73	56,6	800	15	13	3,72	248	274	1,128
MCFS320		53,4					294	320	1,320
MCFS374	80	56,6					348	374	1,576
MCFS420		53,4					394	420	1,768
MCFS474	86,5	56,6					448	474	2,034
MCSF520		53,4					494	520	2,236
MCSF574	93,5	56,6					548	574	2,512
MCSF620		53,4					594	620	2,714
MCSF674	100	56,6					648	674	3,000
MCSF720		53,4					694	720	3,202
MCSF774	106,5	56,6					748	774	3,508
MCSF820		53,4					794	820	3,700
MCSF874	113	56,6	848	874	4,016				
MCSF920		53,4	894	920	4,218				

PRODUCT DESCRIPTION

Roller built on the M base series with tapering obtained using polypropylene sectors.
They are used in idler curves with medium loads that are voluminous in size.