

art.LKS/A

MOBILE SUPPORTS WITH AUTOMATICALLY CONTROLLED SAFETY DEVICE TO CE REGULATIONS mod.20/60 of large dimensions in nitrided steel, bronze flange nuts CFB/A, CDS/A and CFB/M with lubricator and accessories.



Assembled LKS/A support.

LKS/A Support - exploded diagram (for vertical/oblique use).

Fitting on the right of the mobile part with the bolts screwed into bushes inserted in the supports*



Fitting on the left of the mobile part with the bolts screwed into bushes inserted in the supports*

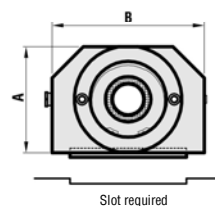
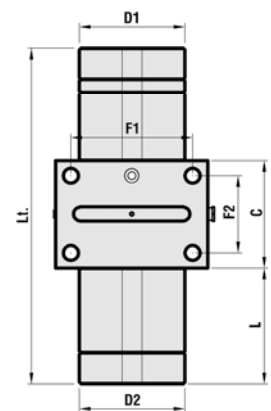
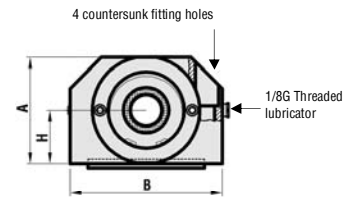
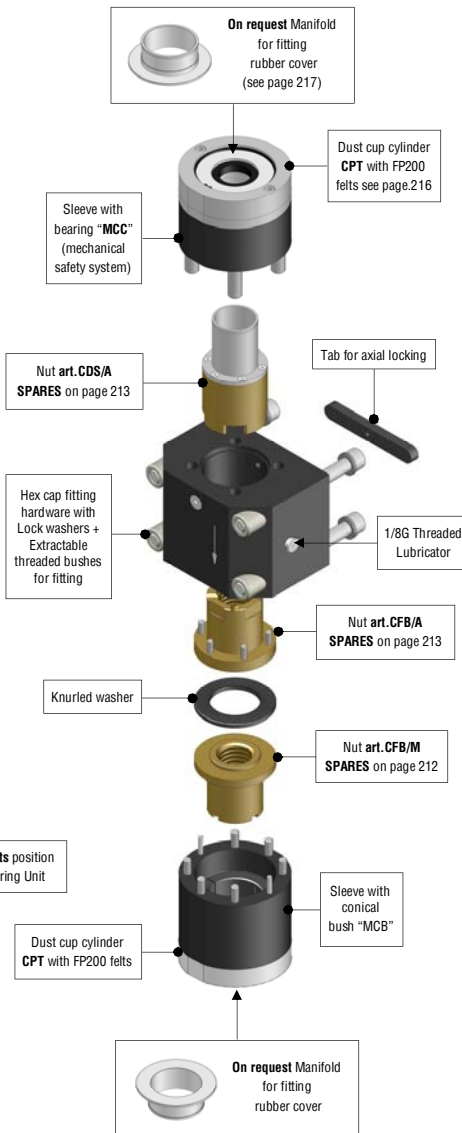
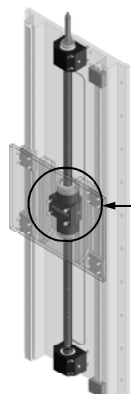

Complete diagrams showing how to fit to the machine are on page 230.

* Extracting the four threaded bushes inserted in LKS/A it is possible to fit the bolts from the opposite direction if the necessary threaded holes on the mobile part are created instead of through holes.
 - Mobile support LKS/A is supplied with an aluminium plate to fit to the machinery as a permanent reference indicating the procedure for resetting the device (see page 227).
 - Lt = Nett size with dust cup cylinders, excluding possible Manifolds for protective covers. Item with right thread available from stock. Approximate weight with accessories and fitting hardware.

| NUTS | CODE Dx | ARTICLE Dx | CODE Sx | ARTICLE Sx | A | B | C | L | Lt. (LKS/A) | H | D1 | D2 | F1 | F2 | Hex.Cap screws for fitting | Slot required for fitting | WEIGHT Kg |
|---------|-------------|----------------|-------------|----------------|-----|-----|-----|-----|-------------|------|------|------|-----|-----|----------------------------|---------------------------|-----------|
| TR 20x4 | 302SM1K204R | LKS-ATR 20x4 R | 302SM1K204L | LKS-ATR 20x4 L | 64 | 100 | 63 | 79 | 210 | 32,5 | Ø75 | Ø75 | 80 | 43 | M10 | Ø12x82x4 | 5,530 |
| TR 25x5 | 302SM1K255R | LKS-ATR 25x5 R | 302SM1K255L | LKS-ATR 25x5 L | 74 | 110 | 70 | 86 | 228 | 37,5 | Ø85 | Ø85 | 87 | 47 | M12 | Ø14x92x4,5 | 7,920 |
| TR 30x6 | 302SM1K306R | LKS-ATR 30x6 R | 302SM1K306L | LKS-ATR 30x6 L | 79 | 120 | 79 | 91 | 245 | 40 | Ø90 | Ø90 | 97 | 56 | M12 | Ø14x102x4,5 | 10,120 |
| TR 35x6 | 302SM1K356R | LKS-ATR 35x6 R | 302SM1K356L | LKS-ATR 35x6 L | 99 | 140 | 99 | 101 | 279 | 50 | Ø100 | Ø100 | 110 | 68 | M14 | Ø14x122x4,5 | 16,410 |
| TR 40x7 | 302SM1K407R | LKS-ATR 40x7 R | 302SM1K407L | LKS-ATR 40x7 L | 109 | 150 | 108 | 106 | 298 | 55 | Ø110 | Ø110 | 118 | 76 | M14 | Ø16x122x5 | 20,820 |
| TR 45x8 | 302SM1K458R | LKS-ATR 45x8 R | 302SM1K458L | LKS-ATR 45x8 L | 119 | 170 | 120 | 131 | 376 | 60 | Ø120 | Ø120 | 136 | 86 | M16 | Ø16x132x5 | 30,650 |
| TR 50x8 | 302SM1K508R | LKS-ATR 50x8 R | 302SM1K508L | LKS-ATR 50x8 L | 129 | 180 | 130 | 131 | 382 | 65 | Ø130 | Ø130 | 146 | 96 | M16 | Ø16x142x5 | 36,610 |
| TR 55x9 | 302SM1K559R | LKS-ATR 55x9 R | 302SM1K559L | LKS-ATR 55x9 L | 144 | 195 | 145 | 149 | 433 | 72,5 | Ø145 | Ø145 | 155 | 105 | M18 | Ø16x152x5 | 51,980 |
| TR 60x9 | 302SM1K609R | LKS-ATR 60x9 R | 302SM1K609L | LKS-ATR 60x9 L | 149 | 200 | 145 | 149 | 432 | 75 | Ø150 | Ø150 | 160 | 105 | M18 | Ø16x162x5 | 56,000 |

- The supports above are shown assembled in the Tecnology KS/A (Groups (see preceding pages) for which it is possible to calculate the total weight by adding them to the weight of the TR screw using the table on pag 182
 - To comply with safety regulations it is obligatory to use the locking tabs, the fitting hardware supplied, and ensuring that the arrows engraved in the supports are all facing in the same direction, which for vertical/oblique movements must be facing downwards.