

art.LK

MOBILE SUPPORTS mod.20/60 of large dimensions in nitrided steel, bronze nuts CFB/HL and CFB/M with lubricator and accessories.

Assembled LK support.

LK Support - exploded diagram.

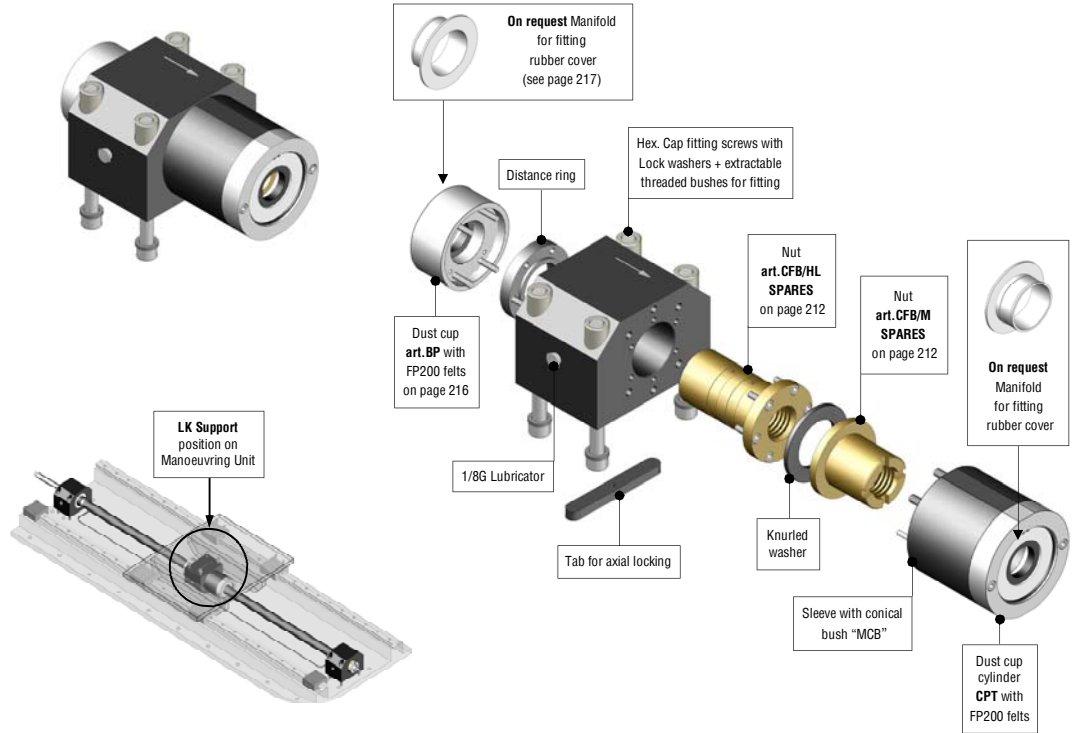

* Extracting the four threaded bushes inserted in support LK it is possible to fit the bolts from the opposite direction if the necessary threaded holes on the mobile part are created instead of through holes.
 - Mobile LK support is supplied with an aluminium plate to fit to the machinery as a permanent reference indicating axial play adjustment (see page 226).

- Complete diagrams showing how to fit to the machine are on page 230.

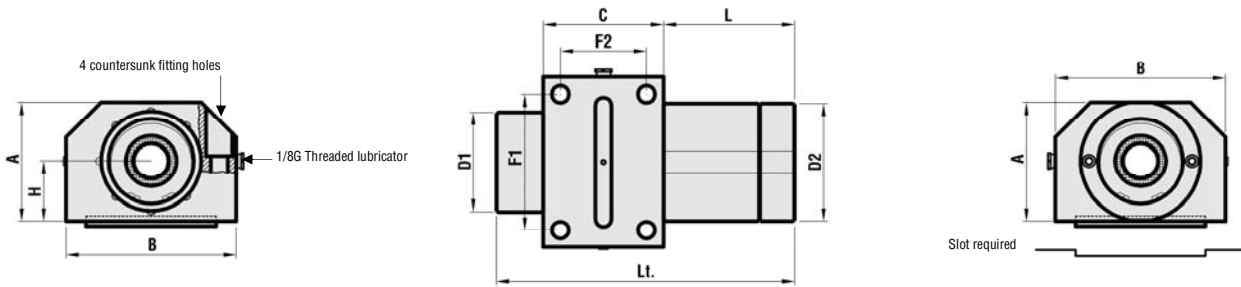

- Lt = Nett size with dust cup cylinders, excluding possible Manifolds for protective covers. Item with right thread available from stock

- Approximate weight with accessories and fitting hardware.

NUTS	CODE Dx	ARTICLE Dx	CODE Sx	ARTICLE Sx	A	B	C	L	Lt. (LK)	H	D1	D2	F1	F2	Hex. Cap screws for fitting	Slot required for fitting	WEIGHT Kg
TR 20x4	302SM0K204R	LK TR 20x4 R	302SM0K204L	LK TR 20x4 L	64	100	63	79	175	32,5	Ø60	Ø75	80	43	M10	Ø12x82x4	4,610
TR 25x5	302SM0K255R	LK TR 25x5 R	302SM0K255L	LK TR 25x5 L	74	110	70	86	195	37,5	Ø70	Ø85	87	47	M12	Ø14x92x4,5	6,760
TR 30x6	302SM0K306R	LK TR 30x6 R	302SM0K306L	LK TR 30x6 L	79	120	79	91	210	40	Ø75	Ø90	97	56	M12	Ø14x102x4,5	8,450
TR 35x6	302SM0K356R	LK TR 35x6 R	302SM0K356L	LK TR 35x6 L	99	140	99	101	240	50	Ø85	Ø100	110	68	M14	Ø14x122x4,5	14,420
TR 36x6	302SM0K366R	LK TR 36x6 R	302SM0K366L	LK TR 36x6 L	99	140	99	101	240	50	Ø85	Ø100	110	68	M14	Ø14x122x4,5	14,350
TR 40x7	302SM0K407R	LK TR 40x7 R	302SM0K407L	LK TR 40x7 L	109	150	108	106	254	55	Ø90	Ø110	118	76	M14	Ø16x122x5	18,280
TR 45x8	302SM0K458R	LK TR 45x8 R	302SM0K458L	LK TR 45x8 L	119	170	120	131	296	60	Ø100	Ø120	136	86	M16	Ø16x132x5	25,030
TR 50x8	302SM0K508R	LK TR 50x8 R	302SM0K508L	LK TR 50x8 L	129	180	130	131	306	65	Ø100	Ø130	146	96	M16	Ø16x142x5	30,210
TR 55x9	302SM0K559R	LK TR 55x9 R	302SM0K559L	LK TR 55x9 L	144	195	145	149	347	72,5	Ø110	Ø145	155	105	M18	Ø16x152x5	42,140
TR 60x9	302SM0K609R	LK TR 60x9 R	302SM0K609L	LK TR 60x9 L	149	200	145	149	347	75	Ø120	Ø150	160	105	M18	Ø16x162x5	46,133

- The supports above are shown assembled in the Technology K (Groups (see preceding pages) for which it is possible to calculate the total weight by adding them to the weight of the TR screw using the table on page 182.
 - To comply with safety regulations it is obligatory to use the locking tabs, the fitting hardware supplied, and ensuring that the arrows engraved in the supports are all facing in the same direction, which for vertical/oblique movements must be facing downwards.