

art.LJ

MOBILE BASES mod.20/60 of large dimensions, flanged and in nitrided steel, with bronze nuts CFB/HL and CFB/M, lubricator and accessories.

Assembled LJ Base.

LJ Base - exploded diagram.



Standard fitting on mobile shelf with through bolts from bottom to top.

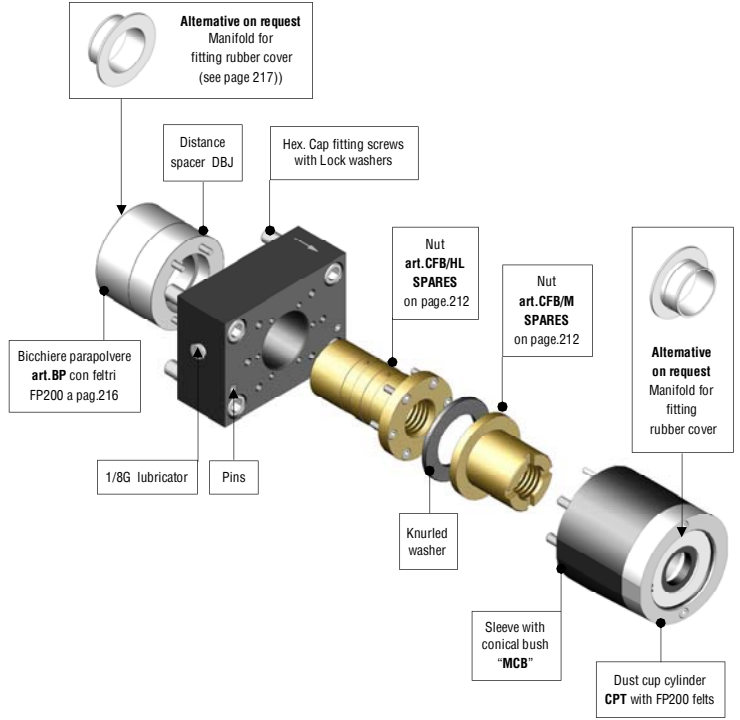
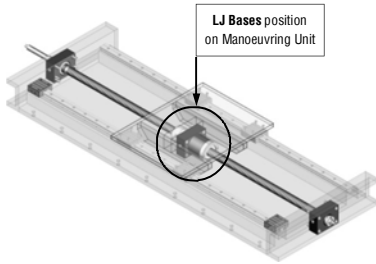

– Mobile Base LJ is supplied with an aluminium plate to fit to the machinery as a permanent reference indicating axial play adjustment (see page 226).

– Complete diagrams showing how to fit to the machine are on page 231

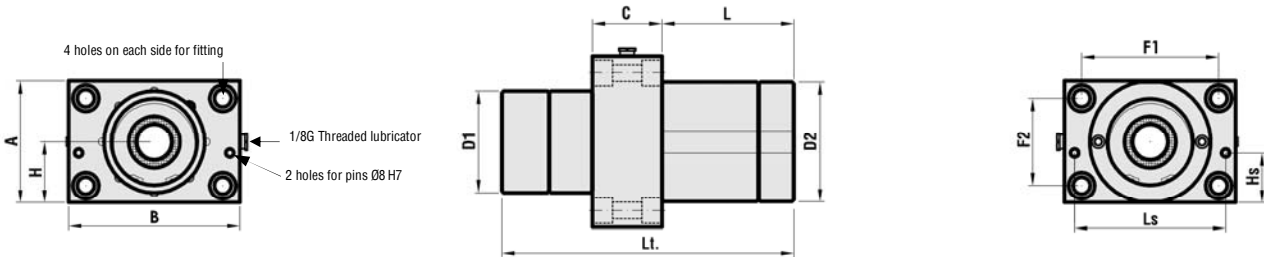

– Lt = Nett size with dust cup cylinders, excluding possible Manifolds for protective covers. Item with right thread available from stock

– Approximate weight with accessories and fitting hardware.

NUTS	CODE Dx	ARTICLE Dx	CODE Sx	ARTICLE Sx	A	B	C	L	Lt. (LJ)	H	D1	D2	F1	F2	Hex. Cap screws for fitting	HS	LS	WEIGHT Kg
TR 20x4	302SMOJ204R	L J TR 20x4 R	302SMOJ204L	L J TR 20x4 L	75	105	39	79	153	37,5	Ø60	Ø75	85	55	M10x50	27	90	4,100
TR 25x5	302SMOJ255R	L J TR 25x5 R	302SMOJ255L	L J TR 25x5 L	85	120	39	86	172	42,5	Ø70	Ø85	95	60	M12x50	30	105	5,780
TR 30x6	302SMOJ306R	L J TR 30x6 R	302SMOJ306L	L J TR 30x6 L	90	130	39	91	188	45	Ø75	Ø90	105	65	M12x50	30	110	6,780
TR 35x6	302SMOJ356R	L J TR 35x6 R	302SMOJ356L	L J TR 35x6 L	100	140	49	101	218	50	Ø85	Ø100	110	70	M14x60	36	120	10,060
TR 36x6	302SMOJ366R	L J TR 36x6 R	302SMOJ366L	L J TR 36x6 L	100	140	49	101	218	50	Ø85	Ø100	110	70	M14x60	36	120	9,990
TR 40x7	302SMOJ407R	L J TR 40x7 R	302SMOJ407L	L J TR 40x7 L	110	150	59	106	233	55	Ø90	Ø110	120	80	M14x70	36	130	13,260
TR 45x8	302SMOJ458R	L J TR 45x8 R	302SMOJ458L	L J TR 45x8 L	120	170	69	131	273	60	Ø100	Ø120	136	86	M16x80	49	150	18,980
TR 50x8	302SMOJ508R	L J TR 50x8 R	302SMOJ508L	L J TR 50x8 L	130	180	69	131	283	65	Ø100	Ø130	146	96	M16x80	53	160	21,730
TR 55x9	302SMOJ559R	L J TR 55x9 R	302SMOJ559L	L J TR 55x9 L	145	195	79	149	323	72,5	Ø110	Ø145	155	105	M18x100	46	170	31,100
TR 60x9	302SMOJ609R	L J TR 60x9 R	302SMOJ609L	L J TR 60x9 L	150	200	79	149	323	75	Ø120	Ø150	160	110	M18x100	46	175	34,600

– The supports above are shown assembled in the Technology J (Groups (see preceding pages) for which it is possible to calculate the total weight by adding them to the weight of the TR screw using the table on page 182.

– To comply with safety regulations it is obligatory to use the fitting hardware supplied, fitting so that the arrow engraved on the Base is in the same direction as the other Bases in the Group, and where used for vertical/oblique movements the arrows must face downwards.