

**art.CFB/VN** **BRONZE FLANGE NUTS “WITH SQUARE FRAMEWORK” TR20/60** with channel and hole for lubrication.

**MATERIAL:** Bronze CuSn12 UNI 7013-72 R300 N/mm<sup>2</sup>, (HB 90/100)

The **CFB/VN** listed below are fitted in the respective **LKS/VN** and **LJS/VN** supports and are available individually as spare parts.

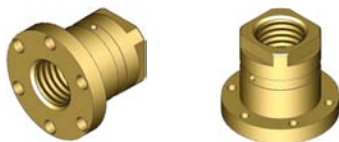

Right threaded nut available from stock.

TRAPEZOIDAL THREAD (Dx)	CODE Dx	ARTICLE Dx	WEIGHT Kg
TR 20x4	302SRC04204R	CFB/VN TR 20x4 Dx	0,250
TR 25x5	302SRC04255R	CFB/VN TR 25x5 Dx	0,360
TR 30x6	302SRC04306R	CFB/VN TR 30x6 Dx	0,450
TR 35x6	302SRC04356R	CFB/VN TR 35x6 Dx	0,780
TR 40x7	302SRC04407R	CFB/VN TR 40x7 Dx	0,930
TR 45x8	302SRC04458R	CFB/VN TR 45x8 Dx	1,220
TR 50x8	302SRC04508R	CFB/VN TR 50x8 Dx	1,350
TR 55x9	302SRC04559R	CFB/VN TR 55x9 Dx	1,880
TR 60x9	302SRC04609R	CFB/VN TR 60x9 Dx	2,040

Left threaded nut made on request.

TRAPEZOIDAL THREAD (Sx)	CODE Sx	ARTICLE Sx	WEIGHT Kg
TR 20x4 Sx	302SRC04204L	CFB/VN TR 20x4 Sx	0,250
TR 25x5 Sx	302SRC04255L	CFB/VN TR 25x5 Sx	0,360
TR 30x6 Sx	302SRC04306L	CFB/VN TR 30x6 Sx	0,450
TR 35x6 Sx	302SRC04356L	CFB/VN TR 35x6 Sx	0,780
TR 40x7 Sx	302SRC04407L	CFB/VN TR 40x7 Sx	0,930
TR 45x8 Sx	302SRC04458L	CFB/VN TR 45x8 Sx	1,220
TR 50x8 Sx	302SRC04508L	CFB/VN TR 50x8 Sx	1,350
TR 55x9 Sx	302SRC04559L	CFB/VN TR 55x9 Sx	1,880
TR 60x9 Sx	302SRC04609L	CFB/VN TR 60x9 Sx	2,040