

art.LJS/VS

MOBILE BASES WITH MECHANICAL SAFETY DEVICE WITH VISUAL CHECKING “SPECIAL STANDARD” SERIES
mod.20/60 of large dimensions, flanged and in nitrided steel, with bronze nuts CFB/HVS and CDS/V lubricator and accessories.

Assembled LJS/VS Base.

Standard fitting on mobile shelf with through bolts From top to bottom.



Optional: **version L JS/VSE** with electric Safety signalling of nut wear.



LJS/VS Base - exploded diagram (for vertical/oblique use).

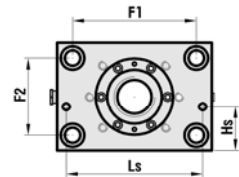
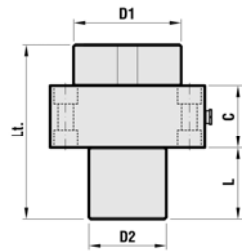
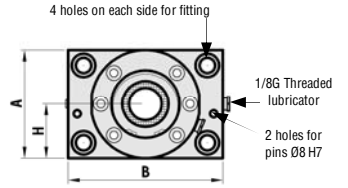
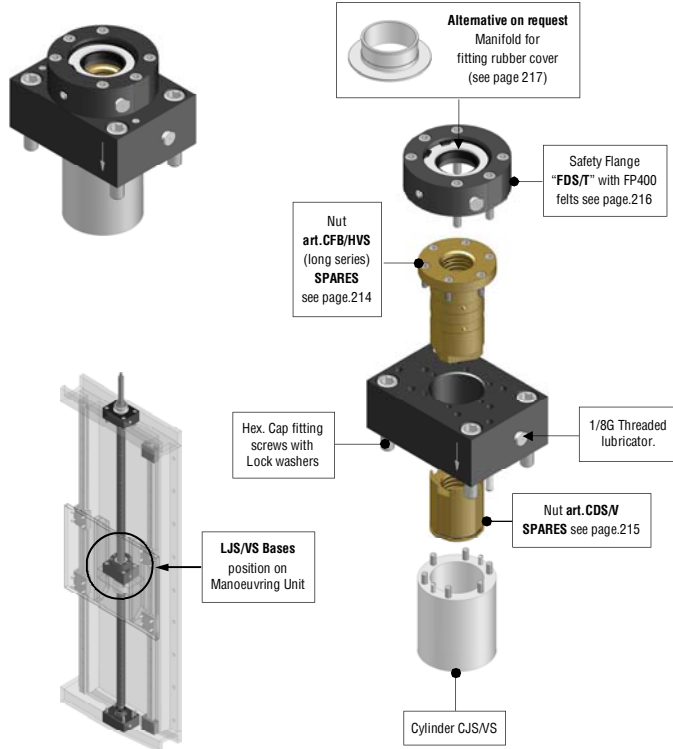

Diagrams showing fitting to the machine are on page 23.

Instructions for correct fitting of the “LJS/VS” Base:

- 1) Check that the **reference letters** shown on both nuts are on the same side as indicated in the illustration on the side.
- 2) Ensure that the distance “**DB**” between the two nuts is within the values indicated in the table below.
- 3) When all the components are fitted ensure that the **reference o-rings** are clearly visible, **completely outside** of the CJS/VS cylinder.
- 4) (Only for VSE) end of travel adjustment for new nuts, with thickness gauge of ...mm inserted between the taper of the nut and the small end of travel wheel, checking that the QSU panel warning light comes on.

TR	20	25	30	35	40	45	50	55	60
DB	3÷3,5	4÷4,5	5÷5,5	5÷5,5	5,5÷6,5	6÷7	6÷7	7÷8	7÷8
Thickness Gauge mm	0,7	0,9	1,0	1,0	1,2	1,4	1,4	1,6	1,6

(OPTIONAL) art.LJS/VSE

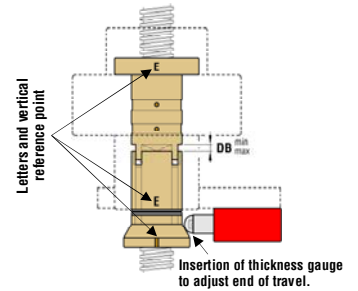

- The LJS/VS (LJS/VSE) Mobile Bases are supplied with an aluminium plate to fit to the machinery as a permanent reference indicating how to check for nut wear (see page 227).
- Lt = **Nett size of support with safety flange**, excluding additional accessories. Item with right thread available from stock. **Approximate weight with accessories and fitting hardware.**

NUT	CODE Dx	ARTICLE Dx	CODE Sx	ARTICLE Sx	A	B	C	L	Lt. (LJS/VS)	H	D1	D2	F1	F2	Hex. Cap screws for fitting	HS	LS	WEIGHT Kg
TR 20x4	302SM3J204R	L JS-VS TR 20x4 R	302SM3J204L	L JS-VS TR 20x4 L	75	105	39	44	116	37,5	□ 60	□ 50	85	55	M10x50	27	90	3,250
TR 25x5	302SM3J255R	L JS-VS TR 25x5 R	302SM3J255L	L JS-VS TR 25x5 L	85	120	39	56	130	42,5	□ 70	□ 60	95	60	M12x50	30	105	4,370
TR 30x6	302SM3J306R	L JS-VS TR 30x6 R	302SM3J306L	L JS-VS TR 30x6 L	90	130	39	70	144	45	□ 75	□ 65	105	65	M12x50	30	110	5,100
TR 35x6	302SM3J356R	L JS-VS TR 35x6 R	302SM3J356L	L JS-VS TR 35x6 L	100	140	49	90	175	50	□ 100	□ 75	110	70	M14x60	36	120	7,950
TR 40x7	302SM3J407R	L JS-VS TR 40x7 R	302SM3J407L	L JS-VS TR 40x7 L	110	150	59	94	189	55	□ 110	□ 80	120	80	M14x70	36	130	10,370
TR 45x8	302SM3J458R	L JS-VS TR 45x8 R	302SM3J458L	L JS-VS TR 45x8 L	120	170	69	90	204	60	□ 120	□ 85	136	86	M16x80	49	150	14,380
TR 50x8	302SM3J508R	L JS-VS TR 50x8 R	302SM3J508L	L JS-VS TR 50x8 L	130	180	69	111	225	65	□ 130	□ 90	146	96	M16x80	53	160	16,800
TR 55x9	302SM3J559R	L JS-VS TR 55x9 R	302SM3J559L	L JS-VS TR 55x9 L	145	195	79	121	253	72,5	□ 145	□ 100	155	105	M18x100	46	170	23,990
TR 60x9	302SM3J609R	L JS-VS TR 60x9 R	302SM3J609L	L JS-VS TR 60x9 L	150	200	79	121	253	75	□ 150	□ 105	160	110	M18x100	46	175	25,580

- The supports above are shown assembled in the **Technology JS/VS** Groups (see preceding pages) for which it is possible to calculate the total weight by adding them to the weight of the TR screw using the table on page 182.
- To comply with safety regulations it is obligatory to use the fitting hardware supplied, fitting so that the arrow engraved on the Base is in the same direction as the other Bases in the Group, and where used for vertical/oblique movements the arrows must face downwards.