

art.DXC

FIXED SUPPORTS FOR SCREWS "BID" Dx/Sx mod.20/60 in nitrided steel, with bronze flange bush and accessories.

Support DXC assembled.

DXC Support - exploded diagram.

Standard fitting on the machine with and without Supports Base.

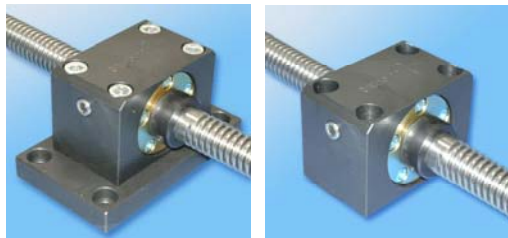

Fitting below machine with and without Supports Base.

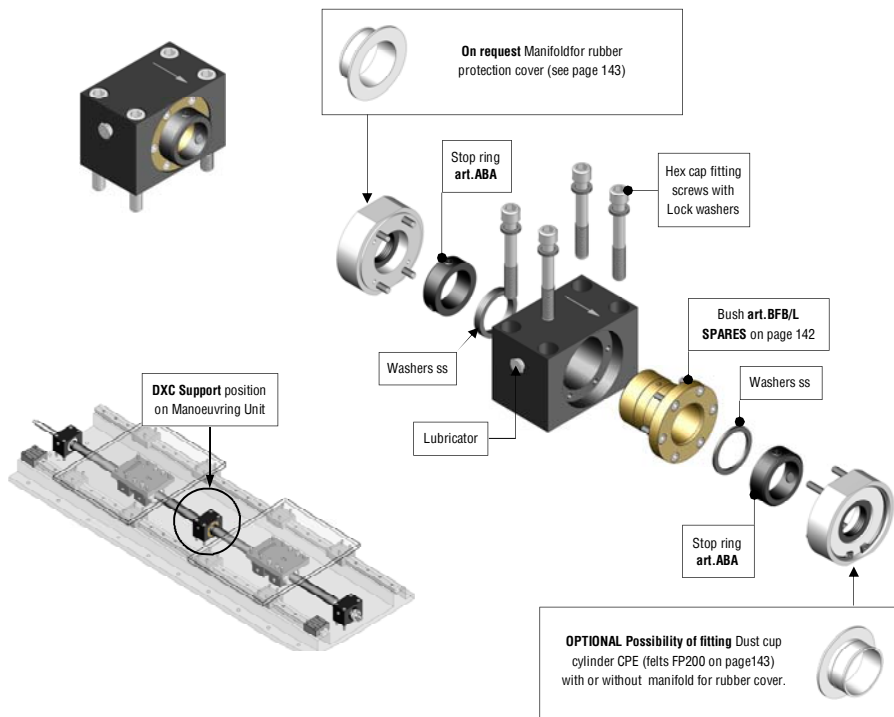
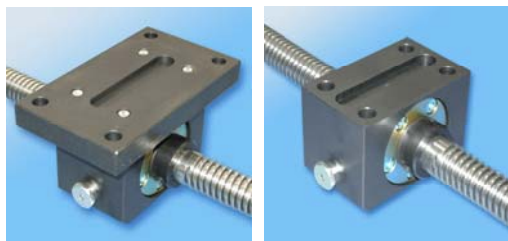

– DXC Support ready for fitting to the machine. Available as necessary, as in the two photos, with Supports Base art.BD LXR (please see page 144).

– Complete diagrams showing how to fit to the machine are on pages 160 and 161.

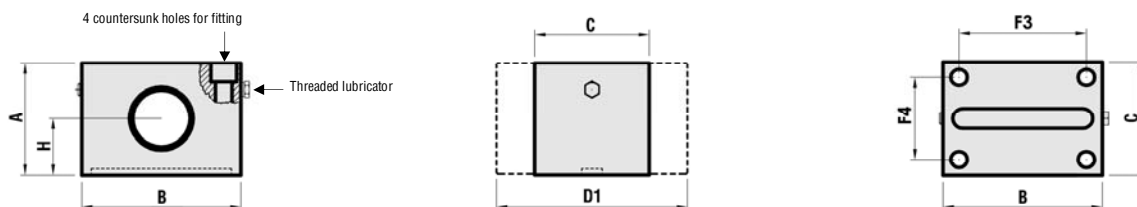

– D1 Nett size with Dust Cups, excluding Manifolds for covers

– Approximate weight with accessories, fitting bolts and Supports Base BD LXR.

| MODEL BY SCREW | CODE | ARTICLE | A | B | C | D1 | H | Ø internal of Bush | F3 | F4 | Hex screws for fitting | Threaded Lubricator | WEIGHT Kg |
|----------------|----------|---------|-----|-----|-----|-----|------|--------------------|-----|----|------------------------|---------------------|-----------|
| TR 20x4 | 301SF220 | DXC 20 | 54 | 80 | 50 | 92 | 27,5 | 20 | 60 | 32 | M8x60 | 1/8G | 1,460 |
| TR 22x5 | 301SF222 | DXC 22 | 54 | 80 | 50 | 92 | 27,5 | 22 | 60 | 32 | M8x60 | 1/8G | 1,460 |
| TR 24x5 | 301SF224 | DXC 24 | 64 | 95 | 55 | 105 | 32,5 | 24 | 75 | 35 | M10x75 | 1/8G | 2,260 |
| TR 25x5 | 301SF225 | DXC 25 | 64 | 95 | 55 | 105 | 32,5 | 25 | 75 | 35 | M10x75 | 1/8G | 2,260 |
| TR 26x5 | 301SF226 | DXC 26 | 64 | 95 | 55 | 105 | 32,5 | 26 | 75 | 35 | M10x75 | 1/8G | 2,260 |
| TR 28x5 | 301SF228 | DXC 28 | 69 | 100 | 60 | 112 | 35 | 28 | 80 | 40 | M10x80 | 1/8G | 2,750 |
| TR 30x6 | 301SF230 | DXC 30 | 69 | 100 | 60 | 112 | 35 | 30 | 80 | 40 | M10x80 | 1/8G | 2,750 |
| TR 32x6 | 301SF232 | DXC 32 | 69 | 100 | 60 | 112 | 35 | 32 | 80 | 40 | M10x80 | 1/8G | 2,750 |
| TR 35x6 | 301SF235 | DXC 35 | 79 | 110 | 70 | 122 | 40 | 35 | 90 | 50 | M10x90 | 1/8G | 4,000 |
| TR 36x6 | 301SF236 | DXC 36 | 79 | 110 | 70 | 122 | 40 | 36 | 90 | 50 | M10x90 | 1/8G | 4,000 |
| TR 40x7 | 301SF240 | DXC 40 | 84 | 120 | 75 | 127 | 42,5 | 40 | 95 | 50 | M12x100 | 1/8G | 4,980 |
| TR 45x8 | 301SF245 | DXC 45 | 89 | 125 | 90 | 152 | 45 | 45 | 100 | 65 | M12x100 | 1/8G | 6,480 |
| TR 46x8 | 301SF246 | DXC 46 | 89 | 125 | 90 | 152 | 45 | 46 | 100 | 65 | M12x100 | 1/8G | 6,480 |
| TR 50x8 | 301SF250 | DXC 50 | 99 | 130 | 90 | 152 | 50 | 50 | 105 | 65 | M12x110 | 1/8G | 7,500 |
| TR 55x9 | 301SF255 | DXC 55 | 109 | 150 | 109 | 181 | 55 | 55 | 122 | 80 | M14x120 | 1/8G | 11,620 |
| TR 60x9 | 301SF260 | DXC 60 | 109 | 150 | 109 | 189 | 55 | 60 | 122 | 80 | M14x120 | 1/8G | 11,240 |

– The supports above are shown assembled in the Excellent Bidirectional Groups (see preceding pages) for which it is possible to calculate the total weight by adding them to the weight of the TR screw using the table on page 127
 – The DXA, DXB and DXC supports have the same external dimensions, milling and fitting holes.

Photos, diagrams and technical data are the exclusive property of Bimeccanica srl. All rights reserved.