



art.LXW

MOBILE SAFETY SUPPORTS mod.16/60 in nitrided steel, with dust felts and bronze flange nut CFB/L.

- Proximity device for signalling to a lamp - (item inclusive of Supports Base BD LXy)

Support LXW assembled with Supports Base

LXW Support - exploded diagram

Fitted to mobile carriage with Supports Base (view from supports side)



Fitted to mobile carriage with Supports Base (view from Supports Base side)

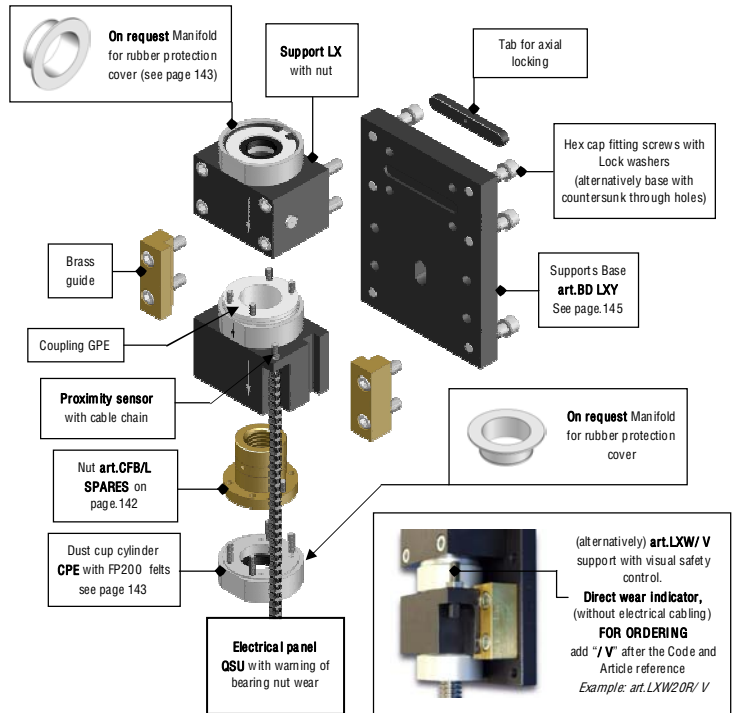
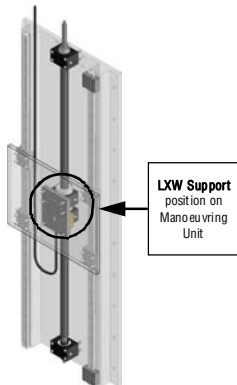
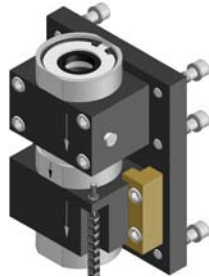

> An aluminium plate, to fit to the machine for permanent reference, showing how to adjust the axial play is supplied the LXW supports.

> Complete diagrams showing how to fit to the machine are on pages 159 and 161.

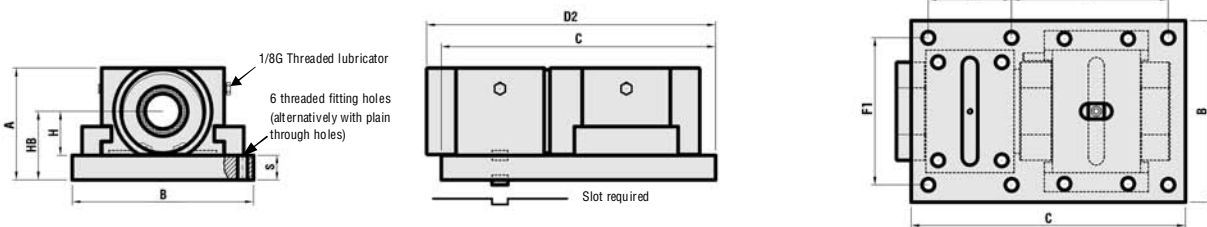

> D2 = Nett size with Dust Cups, excluding Manifolds for covers - Support with right threaded nut available from stock.

> Approximate weight with accessories, fitting bolts and Supports Base BD LXy

NUT CFB/L	CODE Dx	ARTICLE Dx	CODE Sx	ARTICLE Sx	A	B	C	D2	S	H	HB	F1	F2	F5	Hex screws for fitting	Slot required for fitting	WEIGHT Kg
	301SM2164R	LXW TR 16x4 R	301SM2164L	LXW TR 16x4 L	64	110	140	150	15	25	40	90	40	80	M8	Ø10x62x4	3,970
	301SM2184R	LXW TR 18x4 R	301SM2184L	LXW TR 18x4 L	64	120	150	158	15	25	40	100	50	80	M8	Ø10x62x4	4,660
	301SM2204R	LXW TR 20x4 R	301SM2204L	LXW TR 20x4 L	69	120	160	171	15	27,5	42,5	100	50	90	M8	Ø12x72x4	5,630
	301SM2225R	LXW TR 22x5 R	301SM2225L	LXW TR 22x5 L	69	120	160	171	15	27,5	42,5	100	50	90	M8	Ø12x72x4	5,630
	301SM2245R	LXW TR 24x5 R	301SM2245L	LXW TR 24x5 L	84	150	190	203	20	32,5	52,5	115	50	110	M10	Ø14x82x4,5	9,870
	301SM2255R	LXW TR 25x5 R	301SM2255L	LXW TR 25x5 L	84	150	190	203	20	32,5	52,5	115	50	110	M10	Ø14x82x4,5	9,870
	301SM2265R	LXW TR 26x5 R	301SM2265L	LXW TR 26x5 L	84	150	190	203	20	32,5	52,5	115	50	110	M10	Ø14x82x4,5	9,870
	301SM2285R	LXW TR 28x5 R	301SM2285L	LXW TR 28x5 L	89	150	200	216	20	35	55	120	50	120	M10	Ø14x92x4,5	11,750
	301SM2306R	LXW TR 30x6 R	301SM2306L	LXW TR 30x6 L	89	150	200	216	20	35	55	120	50	120	M10	Ø14x92x4,5	11,750
	301SM2326R	LXW TR 32x6 R	301SM2326L	LXW TR 32x6 L	89	150	200	216	20	35	55	120	50	120	M10	Ø14x92x4,5	11,750
	301SM2356R	LXW TR 35x6 R	301SM2356L	LXW TR 35x6 L	99	160	220	231	20	40	60	130	70	120	M10	Ø14x102x4,5	15,160
	301SM2366R	LXW TR 36x6 R	301SM2366L	LXW TR 36x6 L	99	160	220	231	20	40	60	130	70	120	M10	Ø14x102x4,5	15,160
	301SM2407R	LXW TR 40x7 R	301SM2407L	LXW TR 40x7 L	109	180	240	254	25	42,5	67,5	145	65	140	M12	Ø16x112x5	19,820
	301SM2458R	LXW TR 45x8 R	301SM2458L	LXW TR 45x8 L	114	180	280	296	25	45	70	150	85	160	M12	Ø16x112x5	24,520
	301SM2468R	LXW TR 46x8 R	301SM2468L	LXW TR 46x8 L	114	180	280	296	25	45	70	150	85	160	M12	Ø16x112x5	24,520
	301SM2508R	LXW TR 50x8 R	301SM2508L	LXW TR 50x8 L	124	200	280	296	25	50	75	155	85	160	M12	Ø16x122x5	27,650
	301SM2559R	LXW TR 55x9 R	301SM2559L	LXW TR 55x9 L	139	220	335	351	30	55	85	180	110	185	M14	Ø16x142x5	43,400
	301SM2609R	LXW TR 60x9 R	301SM2609L	LXW TR 60x9 L	139	220	335	355	30	55	85	180	110	185	M14	Ø16x142x5	43,000

> The supports above are shown assembled in the Excellent Safety Groups (see preceding pages) for which it is possible to calculate the total weight by adding them to the weight of the TR screw using the table on pag 127.
 > To comply with safety regulations it is obligatory to use the locking tabs, the fitting hardware supplied, and ensuring that the arrows engraved in the supports are all facing in the same direction, which for vertical/oblique movements must be facing downwards.

Photos, diagrams and technical data are the exclusive property of Bimeccanica srl. All rights reserved.