

art.LX

MOBILE SUPPORTS mod.10/60 in nitrided steel, with dust felts and bronze flange nut **CFB/L**, and accessories.
(article includes Supports Base **BD LXR**)

LX support assembled with Supports Base

LX support - exploded diagram

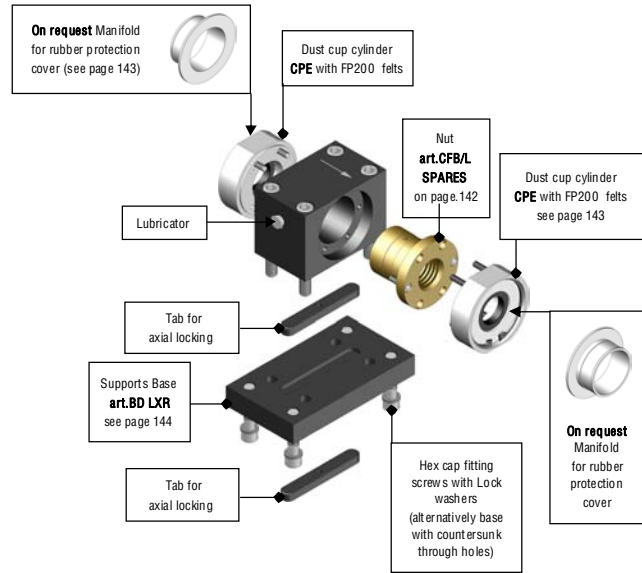
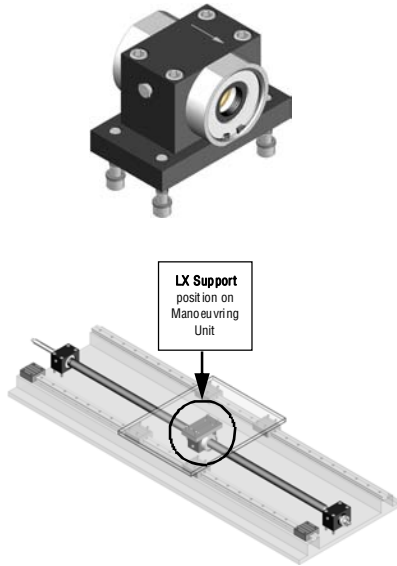

> > Complete diagrams showing how to fit to the machine are on pages 158 and 160.

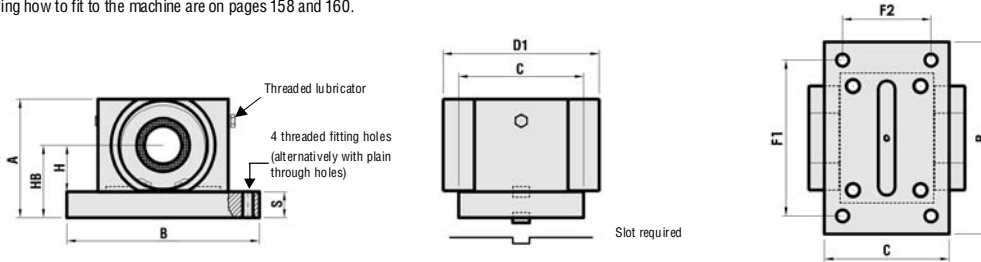

> D1 = Nett size with Dust Cups, excluding Manifolds for covers - Support with right threaded nut available from stock.

> Approximate weight with accessories, fitting bolts and Supports Base BD LXR

NUT CFB/L	CODE Dx	ARTICLE Dx	CODE Sx	ARTICLE Sx	A	B BD LXR	C	D1	S	H	HB	F1	F2	Hex screws for fitting	Slot required for fitting	Lubricator thread	WEIGHT Kg
TR 10x2	301SM0102R	LX TR 10x2 R	301SM0102L	LX TR 10x2 L	46	85	50	68	12	17,5	29,5	69	34	M6	Ø5x42x3	M6x1	0,820
TR 10x3	301SM0103R	LX TR 10x3 R	301SM0103L	LX TR 10x3 L	46	85	50	68	12	17,5	29,5	69	34	M6	Ø5x42x3	M6x1	0,820
TR 12x3	301SM0123R	LX TR 12x3 R	301SM0123L	LX TR 12x3 L	51	90	50	69	12	20	32	74	34	M6	Ø6x47x3	M6x1	0,950
TR 14x3	301SM0143R	LX TR 14x3 R	301SM0143L	LX TR 14x3 L	59	105	60	75	15	22,5	37,5	85	40	M8	Ø8x52x3,5	M6x1	1,450
TR 14x4	301SM0144R	LX TR 14x4 R	301SM0144L	LX TR 14x4 L	59	105	60	75	15	22,5	37,5	85	40	M8	Ø8x52x3,5	M6x1	1,450
TR 16x4	301SM0164R	LX TR 16x4 R	301SM0164L	LX TR 16x4 L	64	110	60	80	15	25	40	90	40	M8	Ø10x62x4	1/8G	1,780
TR 18x4	301SM0184R	LX TR 18x4 R	301SM0184L	LX TR 18x4 L	64	120	70	85	15	25	40	100	50	M8	Ø10x62x4	1/8G	2,180
TR 20x4	301SM0204R	LX TR 20x4 R	301SM0204L	LX TR 20x4 L	69	120	70	92	15	27,5	42,5	100	50	M8	Ø12x72x4	1/8G	2,550
TR 22x5	301SM0225R	LX TR 22x5 R	301SM0225L	LX TR 22x5 L	69	120	70	92	15	27,5	42,5	100	50	M8	Ø12x72x4	1/8G	2,550
TR 24x5	301SM0245R	LX TR 24x5 R	301SM0245L	LX TR 24x5 L	84	145	80	105	20	32,5	52,5	115	50	M10	Ø14x82x4,5	1/8G	4,300
TR 25x5	301SM0255R	LX TR 25x5 R	301SM0255L	LX TR 25x5 L	84	145	80	105	20	32,5	52,5	115	50	M10	Ø14x82x4,5	1/8G	4,300
TR 26x5	301SM0265R	LX TR 26x5 R	301SM0265L	LX TR 26x5 L	84	145	80	105	20	32,5	52,5	115	50	M10	Ø14x82x4,5	1/8G	4,300
TR 28x5	301SM0285R	LX TR 28x5 R	301SM0285L	LX TR 28x5 L	89	150	80	112	20	35	55	120	50	M10	Ø14x92x4,5	1/8G	4,880
TR 30x6	301SM0306R	LX TR 30x6 R	301SM0306L	LX TR 30x6 L	89	150	80	112	20	35	55	120	50	M10	Ø14x92x4,5	1/8G	4,880
TR 32x6	301SM0326R	LX TR 32x6 R	301SM0326L	LX TR 32x6 L	89	150	80	112	20	35	55	120	50	M10	Ø14x92x4,5	1/8G	4,880
TR 35x6	301SM0356R	LX TR 35x6 R	301SM0356L	LX TR 35x6 L	99	160	100	122	20	40	60	130	70	M10	Ø14x102x4,5	1/8G	6,850
TR 36x6	301SM0366R	LX TR 36x6 R	301SM0366L	LX TR 36x6 L	99	160	100	122	20	40	60	130	70	M10	Ø14x102x4,5	1/8G	6,850
TR 40x7	301SM0407R	LX TR 40x7 R	301SM0407L	LX TR 40x7 L	109	180	100	127	25	42,5	67,5	145	65	M12	Ø16x112x5	1/8G	8,810
TR 45x8	301SM0458R	LX TR 45x8 R	301SM0458L	LX TR 45x8 L	114	185	120	152	25	45	70	150	85	M12	Ø16x112x5	1/8G	11,250
TR 46x8	301SM0468R	LX TR 46x8 R	301SM0468L	LX TR 46x8 L	114	185	120	152	25	45	70	150	85	M12	Ø16x112x5	1/8G	11,250
TR 50x8	301SM0508R	LX TR 50x8 R	301SM0508L	LX TR 50x8 L	124	190	120	152	25	50	75	155	85	M12	Ø16x122x5	1/8G	12,370
TR 55x9	301SM0559R	LX TR 55x9 R	301SM0559L	LX TR 55x9 L	139	220	150	181	30	55	85	180	110	M14	Ø16x142x5	1/8G	16,740
TR 60x9	301SM0609R	LX TR 60x9 R	301SM0609L	LX TR 60x9 L	139	220	150	189	30	55	85	180	110	M14	Ø16x142x5	1/8G	19,780

The supports above are shown assembled in the **Excellent steel** Groups (see preceding pages) for which it is possible to calculate the total weight by adding them to the weight of the TR screw using the table on page 127.
 > Using the **mobile support LX without Supports Base** it is necessary to ensure that the same holes are provided as for supports **DXA** and **DXB** (see preceding pages).
 > To comply with safety regulations it is obligatory to use the locking tabs, the fitting hardware supplied, and ensuring that the arrows engraved in the supports are all facing in the same direction, which for vertical/oblique movements must be facing downwards.

Photos, diagrams and technical data are the exclusive property of Bimeccanica srl. All rights reserved.