

art.CCN/A NYLON CYLINDRICAL NUTS TR10/40 with slot for mounting, channel and hole for lubrication.

MATERIAL: black polyacetal POM.C (FDA approved) R70 N/mm²

The CCN/A nuts are fitted as standard to mobile supports LVO,LZO of the Compact Light series and are available individually as spare parts.

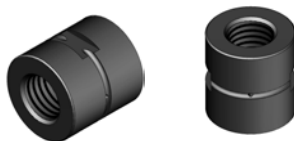

Right threaded nut available from stock.

NUT CCN/A (Dx)	CODE Dx	ARTICLE Dx	WEIGHT Kg
* TR 10x2	300SRCA0102R	CCN/A TR 10x2 Dx	0,006
TR 10x3	300SRCA0103R	CCN/A TR 10x3 Dx	0,006
TR 12x3	300SRCA0123R	CCN/A TR 12x3 Dx	0,012
* TR 14x3	300SRCA0143R	CCN/A TR 14x3 Dx	0,010
TR 14x4	300SRCA0144R	CCN/A TR 14x4 Dx	0,010
TR 16x4	300SRCA0164R	CCN/A TR 16x4 Dx	0,017
TR 18x4	300SRCA0184R	CCN/A TR 18x4 Dx	0,030
TR 20x4	300SRCA0204R	CCN/A TR 20x4 Dx	0,046
* TR 22x5	300SRCA0225R	CCN/A TR 22x5 Dx	0,046
* TR 24x5	300SRCA0245R	CCN/A TR 24x5 Dx	0,066
TR 25x5	300SRCA0255R	CCN/A TR 25x5 Dx	0,066
* TR 26x5	300SRCA0265R	CCN/A TR 26x5 Dx	0,066
* TR 28x5	300SRCA0285R	CCN/A TR 28x5 Dx	0,080
TR 30x6	300SRCA0306R	CCN/A TR 30x6 Dx	0,080
* TR 32x6	300SRCA0326R	CCN/A TR 32x6 Dx	0,080
TR 35x6	300SRCA0356R	CCN/A TR 35x6 Dx	0,150
TR 36x6	300SRCA0366R	CCN/A TR 36x6 Dx	0,140
TR 40x7	300SRCA0407R	CCN/A TR 40x7 Dx	0,190

Left threaded nut made on request.

NUT CCN/A (Sx)	CODE Sx	ARTICLE Sx	WEIGHT Kg
* TR 10x2 Sx	300SRCA0102L	CCN/A TR 10x2 Sx	0,006
TR 10x3 Sx	300SRCA0103L	CCN/A TR 10x3 Sx	0,006
TR 12x3 Sx	300SRCA0123L	CCN/A TR 12x3 Sx	0,012
* TR 14x3 Sx	300SRCA0143L	CCN/A TR 14x3 Sx	0,010
TR 14x4 Sx	300SRCA0144L	CCN/A TR 14x4 Sx	0,010
TR 16x4 Sx	300SRCA0164L	CCN/A TR 16x4 Sx	0,017
TR 18x4 Sx	300SRCA0184L	CCN/A TR 18x4 Sx	0,030
TR 20x4 Sx	300SRCA0204L	CCN/A TR 20x4 Sx	0,046
* TR 22x5 Sx	300SRCA0225L	CCN/A TR 22x5 Sx	0,046
* TR 24x5 Sx	300SRCA0245L	CCN/A TR 24x5 Sx	0,066
TR 25x5 Sx	300SRCA0255L	CCN/A TR 25x5 Sx	0,066
* TR 26x5 Sx	300SRCA0265L	CCN/A TR 26x5 Sx	0,066
* TR 28x5 Sx	300SRCA0285L	CCN/A TR 28x5 Sx	0,080
TR 30x6 Sx	300SRCA0306L	CCN/A TR 30x6 Sx	0,080
* TR 32x6 Sx	300SRCA0326L	CCN/A TR 32x6 Sx	0,080
TR 35x6 Sx	300SRCA0356L	CCN/A TR 35x6 Sx	0,150
TR 36x6 Sx	300SRCA0366L	CCN/A TR 36x6 Sx	0,140
TR 40x7 Sx	300SRCA0407L	CCN/A TR 40x7 Sx	0,190

* The items marked with an asterisk are less frequently used.

WARNING: for replacing the nuts of the LVO/LVZO supports please refer to the instructions on page 85.