

art.LVZO

ADJUSTABLE MOBILE SUPPORTS mod.10/40 in anodized aluminium alloy, of reduced dimensions, with nylon nut **CCN/A**.
(article includes Supports Base **BD LVZO** and accessories)

LVZO support assembled with Supports Base



Fitting on mobile support with Supports Base below



Standard fitting on mobile support with Supports Base on top

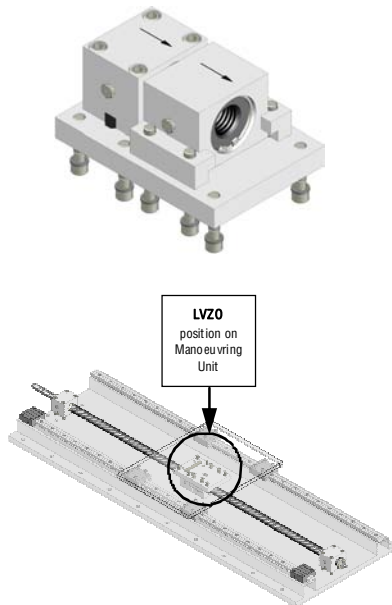

LVZO position on Manoeuvring Unit

LVZO support - exploded diagram

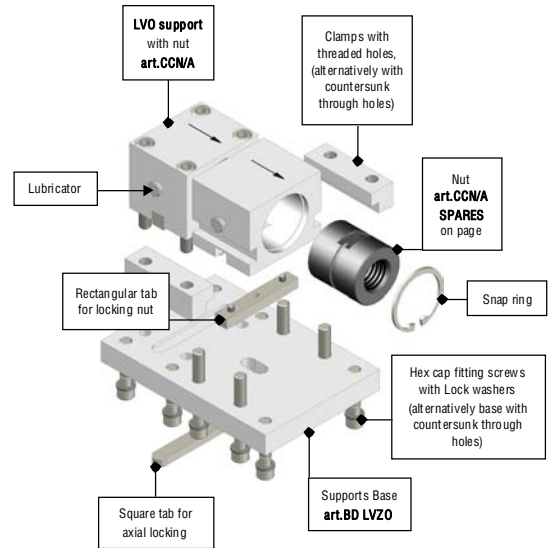

LVO support with nut art.CCN/A

Clamps with threaded holes, (alternatively with countersunk through holes)

Lubricator

Nut art.CCN/A SPARES on page

Rectangular tab for locking nut

Snap ring

Hex cap fitting screws with Lock washers (alternatively base with countersunk through holes)

Square tab for axial locking

Supports Base art.BD LVZO

- > An aluminium plate, to fit to the machine for permanent reference, showing how to adjust the axial play is supplied the **LVZO supports** (please see page 96).
- > In cases where stain resistance is not required the LVZO support is supplied with fitting hardware and components in zinc coated steel.
- > Complete diagrams showing how to fit to the machine are on pages 101 and 103.

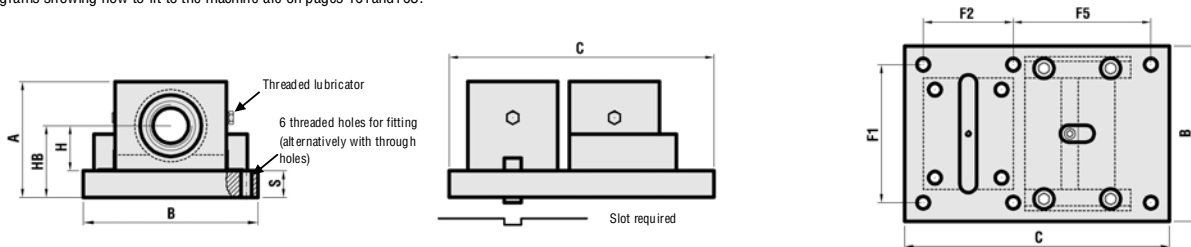

> **C = Nett size of the Base BD LVZO (see page.119)** - Support with right threaded nut available from stock.

> **Approximate weight with accessories, fitting bolts and Supports Base BD LVZO.**

NUT CCB/N	CODE Dx	ARTICLE Dx	CODE Sx	ARTICLE Sx	A	B	C BD LVZO	S	H	HB	F1	F2	F5	Hex screws for fitting	Slot required for fitting	Threaded Lubricator	WEIGHT Kg
TR 10x2	300SM5102R	LVZO TR 10x2 R	300SM5102L	LVZO TR 10x2 L	41	75	100	12	15	27	59	34	50	M6	Ø10x57x2	M6x1	0,580
TR 10x3	300SM5103R	LVZO TR 10x3 R	300SM5103L	LVZO TR 10x3 L	41	75	100	12	15	27	59	34	50	M6	Ø10x57x2	M6x1	0,580
TR 12x3	300SM5123R	LVZO TR 12x3 R	300SM5123L	LVZO TR 12x3 L	46	80	110	12	17,5	29,5	64	34	60	M6	Ø10x62x2	M6x1	0,720
TR 14x3	300SM5143R	LVZO TR 14x3 R	300SM5143L	LVZO TR 14x3 L	46	80	110	12	17,5	29,5	64	34	60	M6	Ø10x62x2	M6x1	0,720
TR 14x4	300SM5144R	LVZO TR 14x4 R	300SM5144L	LVZO TR 14x4 L	46	80	110	12	17,5	29,5	64	34	60	M6	Ø10x62x2	M6x1	0,720
TR 16x4	300SM5164R	LVZO TR 16x4 R	300SM5164L	LVZO TR 16x4 L	54	90	130	15	20	35	70	40	70	M8	Ø12x69x3	1/8G	1,130
TR 18x4	300SM5184R	LVZO TR 18x4 R	300SM5184L	LVZO TR 18x4 L	59	100	140	15	22,5	37,5	80	45	75	M8	Ø12x74x3	1/8G	1,380
TR 20x4	300SM5204R	LVZO TR 20x4 R	300SM5204L	LVZO TR 20x4 L	64	100	155	15	25	40	80	50	85	M8	Ø12x79x3	1/8G	1,620
TR 22x5	300SM5225R	LVZO TR 22x5 R	300SM5225L	LVZO TR 22x5 L	64	100	155	15	25	40	80	50	85	M8	Ø12x79x3	1/8G	1,620
TR 24x5	300SM5245R	LVZO TR 24x5 R	300SM5245L	LVZO TR 24x5 L	74	130	180	20	27,5	47,5	95	50	100	M10	Ø14x91x4	1/8G	2,700
TR 25x5	300SM5255R	LVZO TR 25x5 R	300SM5255L	LVZO TR 25x5 L	74	130	180	20	27,5	47,5	95	50	100	M10	Ø14x91x4	1/8G	2,700
TR 26x5	300SM5265R	LVZO TR 26x5 R	300SM5265L	LVZO TR 26x5 L	74	130	180	20	27,5	47,5	95	50	100	M10	Ø14x91x4	1/8G	2,700
TR 28x5	300SM5285R	LVZO TR 28x5 R	300SM5285L	LVZO TR 28x5 L	79	130	185	20	30	50	100	50	105	M10	Ø14x96x4	1/8G	3,080
TR 30x6	300SM5306R	LVZO TR 30x6 R	300SM5306L	LVZO TR 30x6 L	79	130	185	20	30	50	100	50	105	M10	Ø14x96x4	1/8G	3,080
TR 32x6	300SM5326R	LVZO TR 32x6 R	300SM5326L	LVZO TR 32x6 L	79	130	185	20	30	50	100	50	105	M10	Ø14x96x4	1/8G	3,080
TR 35x6	300SM5356R	LVZO TR 35x6 R	300SM5356L	LVZO TR 35x6 L	89	140	210	20	35	55	110	70	110	M10	Ø14x106x4	1/8G	3,950
TR 36x6	300SM5366R	LVZO TR 36x6 R	300SM5366L	LVZO TR 36x6 L	89	140	210	20	35	55	110	70	110	M10	Ø14x106x4	1/8G	3,950
TR 40x7	300SM5407R	LVZO TR 40x7 R	300SM5407L	LVZO TR 40x7 L	104	160	230	25	40	65	125	65	130	M12	Ø16x118x4	1/8G	5,890

- > As per the diagram, the fitting clamps are supplied with threaded holes but on request they can be supplied with countersunk through holes. For the overall weight of the Group with screw please see the table on page 107.
- > To comply with safety regulations it is obligatory to use the locking tabs, the fitting hardware supplied, and ensuring that the arrows engraved in the supports are all facing in the same direction, which for vertical/oblique movements must be facing downwards.