

Wheels



Segment wheels $Z=15$



3" and 197 teeth sixfold wheel



Special segments

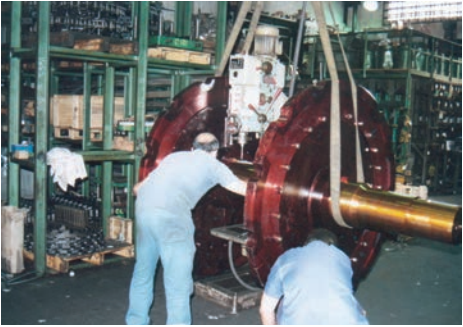

Driving group assembly



Segment wheels

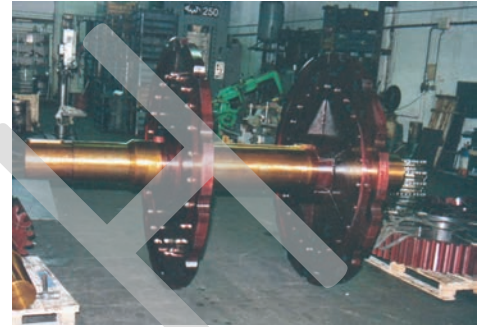

Driving group

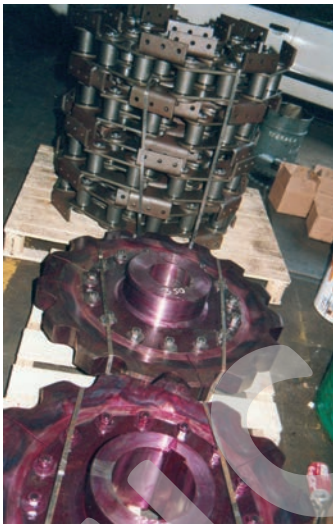

Prepared material



Plate conveyor



Driving group assembly

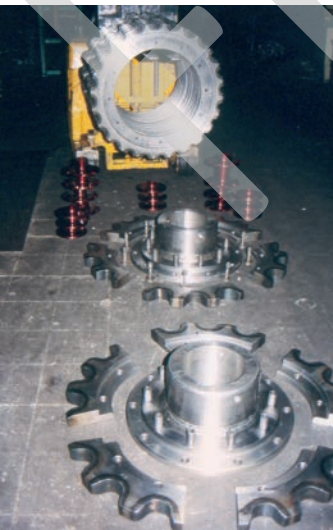

Segment wheels



Driving group

One-piece plain wheels for bucket elevators

One-piece plain wheels for bucket elevators, for chain type DIN 764-DIN 766 and shackles DIN 5699-DIN 745, or chain type LH and special ATS bucket attachments. For rear mounted buckets (version with lateral supports) or side mounted buckets (without lateral supports on request). Made of special alloy steel, with high resistance to wear; available with additional induction tempering of the area of contact with the chain. Available with peripheral relief slots for material discharge; bored and keyed according to request.

Code	Pitch line diameter Dp (mm)	External diameter D (mm)	Chain diameter mm		Dimensions mm			Mass for wheel kg \approx
			DIN 764 DIN 766	LH	A	C	E	
RL 10/350	350	360	10	-	16	60	70	35
RL 10/400	400	410	10	-	16	70	80	48
RL 13/400	400	420	13	14	19	80	90	58
RL 13/500	500	510	13	14	19	80	90	85
RL 16/500	500	515	16	16	22	90	100	95
RL 18/500	500	520	18	16	23	100	110	110
RL 20/500	500	520	20	19	26	110	120	120
RL 16/630	630	645	16	16	22	95	120	165
RL 18/630	630	645	18	19	23	105	120	180
RL 20/630	630	650	20	19	26	110	130	195
RL 23/630	630	650	23	22	30	120	140	210
RL 16/710	710	715	16	16	22	95	140	220
RL 18/710	710	720	18	19	23	105	140	230
RL 20/710	710	720	20	22	26	110	150	255
RL 23/710	710	730	23	22	30	125	160	285
RL 26/710	710	730	26	26	35	140	160	305
RL 20/800	800	810	20	22	28	115	140	325
RL 23/800	800	810	23	22	30	125	160	365
RL 26/800	800	820	26	26	35	140	160	395
RL 30/800	800	820	30	30	41	150	170	415

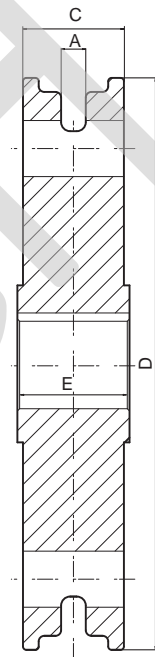

Toothed wheels for submerged scraper conveyors (SSC)

Suitable for conveyors with LH/MH chain equipment. Hub manufactured with welded design, with pilot bore (unmachined) or bored and keyed according to request. Replaceable teeth made of NiCrMo alloy with case hardened, highly wear resistant surface; teeth fixed on the hub by means of bolts and a counter disc.

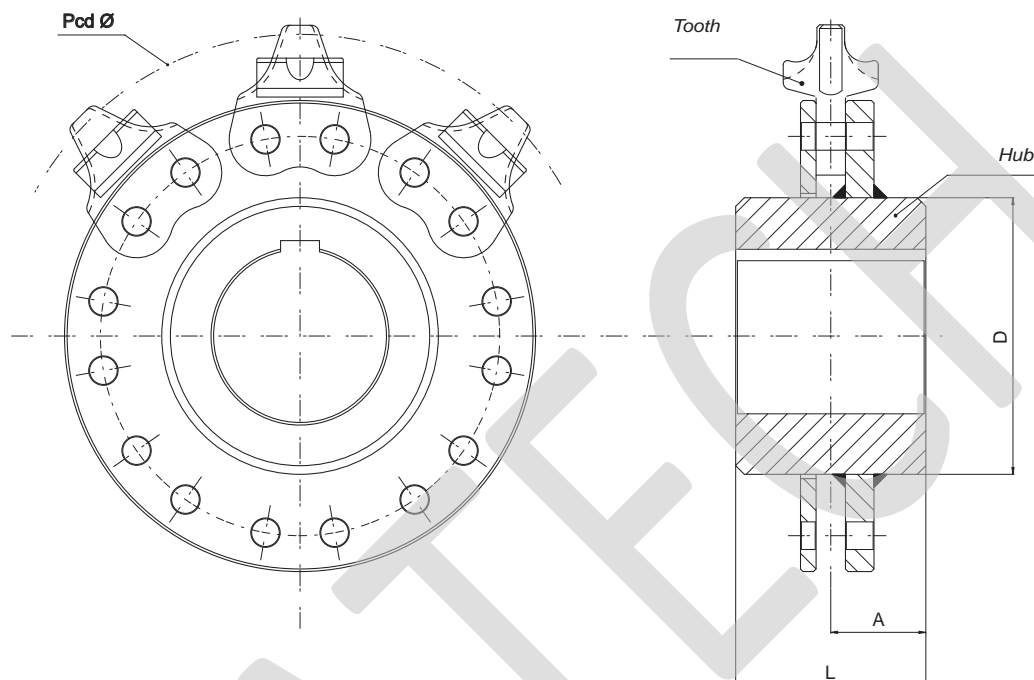

Code	Chain	No. teeth Z	Pitch circle Ø Pcd	Dimensions mm				Mass kg ≈
				Hub dimensions (standard values)				
				Ø Pilot bore (diameter)	D	L	A	
RD22-Z8	LH 22x86	8	440	65	190	160	80	90
RD22-Z9		9	495	65	230	160	80	100
RD22-Z10		10	549	65	250	160	80	110
RD22-Z11		11	604	65	280	160	80	130
RD22-Z12		12	658	70	300	170	85	160
RD26-Z7	LH 26x100	7	449	70	230	160	80	80
RD26-Z8		8	512	70	250	160	80	120
RD26-Z9		9	575	100	280	160	80	140
RD26-Z10		10	639	100	280	180	90	170
RD26-Z11		11	703	100	300	180	90	220
RD30-Z7	LH 30x120	7	540	100	240	180	90	95
RD30-Z8		8	615	120	320	180	90	150
RD30-Z9		9	691	120	320	180	90	175
RD30-Z10		10	767	120	320	180	90	210
RD30-Z11		11	844	120	320	180	90	250
RD34-Z7	LH 34x136	7	612	100	260	220	110	160
RD34-Z8		8	698	120	320	220	110	225
RD34-Z9		9	783	120	320	220	110	260
RD34-Z10		10	870	120	320	220	110	300
RD34-Z11		11	956	120	320	220	110	350

Other hub dimensions and any other number of teeth on request.

Toothed wheels for bucket elevators with chain LH

Made of welded steel fabrication; hub available with raw or machined bore according to request, keyed or machined for keyless clamping systems. Any other number of teeth on request.

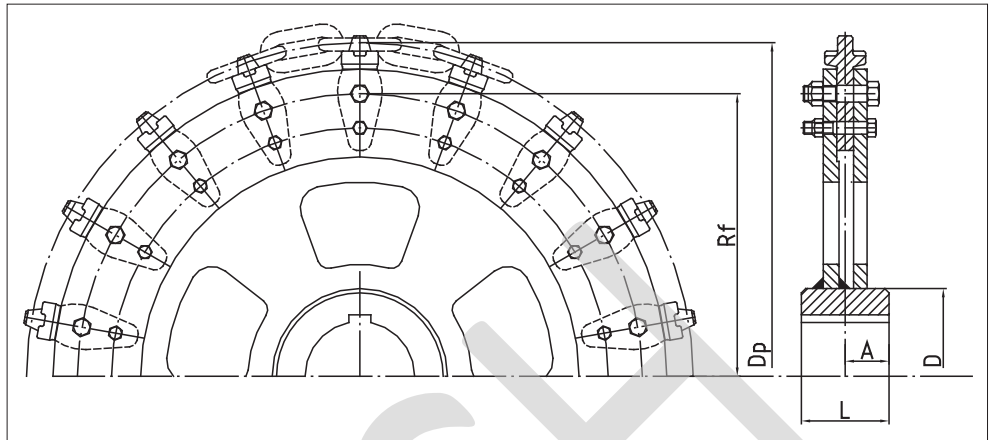
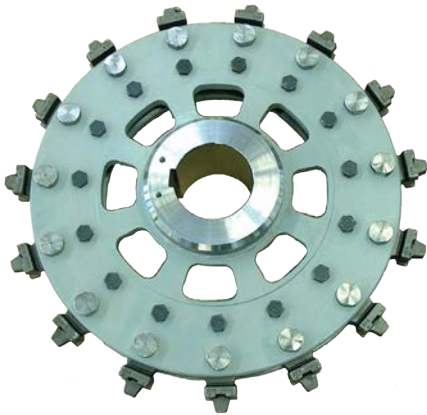

Chain	Teeth no.	Dimensions mm		Standard values		
		\emptyset	Main hole centre radius Rf	D	L	A
		Pitch line Dp mm				
LH14x50	13	415	160	160	100	50
	14	447	176	160	120	60
	15	478	192	160	120	60
	18	574	240	160	120	60
LH16x64	14	571	214	200	170	85
	15	612	234	200	170	85
	16	653	254.5	200	170	85
	17	694	275	210	180	90
	18	734	295	210	180	90
	20	816	336.5	210	180	90
LH 19x75	22	897	377	210	180	90
	14	670	247	280	180	90
	15	718	271	280	180	90
	16	765	295	280	180	90
	17	813	319	280	180	90
	18	860	343	280	180	90
LH 22x86	20	956	391	280	180	90
	22	1051	439	280	180	90
	14	768	300	280	180	90
	15	823	327.5	280	180	90
	16	878	355.5	280	180	90
	17	932	383	280	180	90
LH 26x100	18	987	410	300	200	100
	20	1096	465	300	200	100
	22	1205	520	300	200	100
	15	956	380	300	200	100
	16	1020	412	300	200	100
	18	1148	476	300	200	100
LH 30x120	20	1274	539.5	300	200	100
	22	1402	603.5	300	200	100
	14	1072	429.5	300	200	100
	15	1148	468	300	200	100
	16	1225	506.5	300	200	100
	18	1377	583	350	200	100
LH 34x136	20	1530	660	350	200	100
	22	1682	736.5	350	200	100
	14	1215	490.5	370	200	100
	15	1301	534	370	200	100
	16	1387	577.5	390	220	110
	18	1560	664	390	220	110
LH 38x144	14	1286	508.5	400	270	135
	15	1378	555	400	270	135
	16	1469	601	400	270	135
	18	1653	693	400	270	135

Reversing wheels for elevators with chain LH

Reverse idler wheels for elevators with chain LH, with bucket attachments by means of pins and sidewalls.

Exchangeable tread segments of the chain rail made of wear resistant steel.

Steel hub in welded construction, available with raw or machined bore according to request, keyed or machined for keyless clamping systems.

Guide disc diameter D_e equal to the chain rail diameter + approx. 400 mm (for D up to 980 mm) or approx 500 mm (for D up to 1280 mm).

Code	Chain	Dimensions mm				No. teeth driving wheel	Mass kg \approx
		D	W	L	Dm		
RR16-560	16x64	560	100	120	120	15	90
RR16-600		600		140	140	16	100
RR16-640		640		140	140	17	110
RR16-680		680		140	140	18	120
RR16-760		760		150	140	20	140
RR19-655	19x75	655	110	140	140	15	140
RR19-700		700		140	140	16	155
RR19-750		750		150	150	17	175
RR19-800		800		150	150	18	200
RR19-900		900		160	160	20	235
RR22-750	22x86	750	140	120	150	15	200
RR22-805		805		120	150	16	225
RR22-860		860		140	160	17	250
RR22-970		970		160	180	19	300
RR22-1025		1025		160	180	20	335
RR22-1130		1130		180	200	22	390
RR26-810	26x100	810	170	140	160	14	280
RR26-870		870		140	160	15	290
RR26-940		940		150	160	16	330
RR26-1000		1000		160	180	17	370
RR26-1065		1065		160	200	18	410
RR26-1190		1190		180	220	20	470
RR30-970	30x120	970	190	150	180	14	380
RR30-1045		1045		160	180	15	420
RR30-1125		1125		180	220	16	480
RR30-1280		1280		200	220	18	530
RR34-1110	34x136	1110	195	200	220	14	495
RR34-1200		1200		200	220	15	550
RR34-1280		1280		200	220	16	610
RR34-1460		1460		220	230	18	690
RR38-1180	38x144	1180	200	200	220	14	560
RR38-1270		1270		200	220	15	630
RR38-1360		1360		220	230	16	680
RR38-1550		1550		240	240	18	760

Other dimensions available on request.

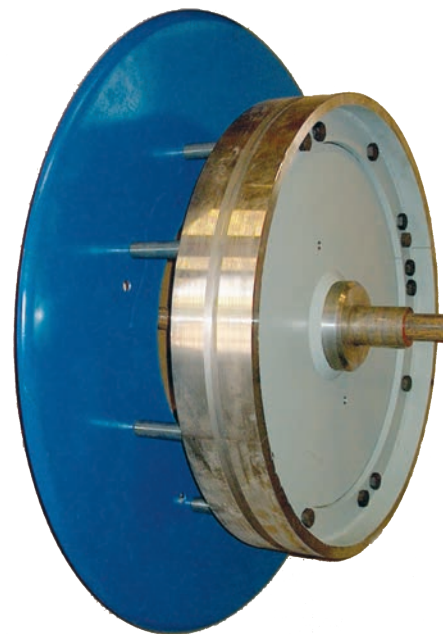
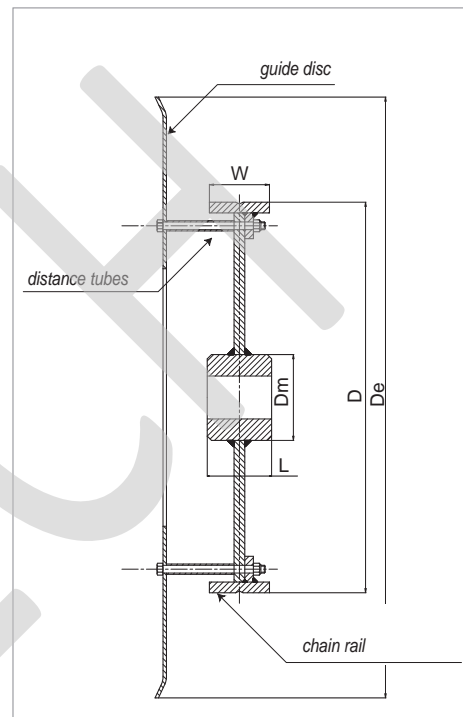

Segmented bucket wheels for elevators

Segmented chain wheels for bucket elevators with chain according to DIN 764-DIN 766 and shackles DIN 5699-DIN 745, or chain type LH and special ATS bucket attachments. For rear mounted buckets (alternatively a version with no rims for buckets with lateral attachment is also available).

Replaceable segments made of special CrMo alloy, highly resistant to wear (min hardness 40 HRC).

Steel hub in welded steel fabrication (type A), available with cleaning slots for material discharge (type B, self-cleaning). Bored and keyed according to the customer's request.

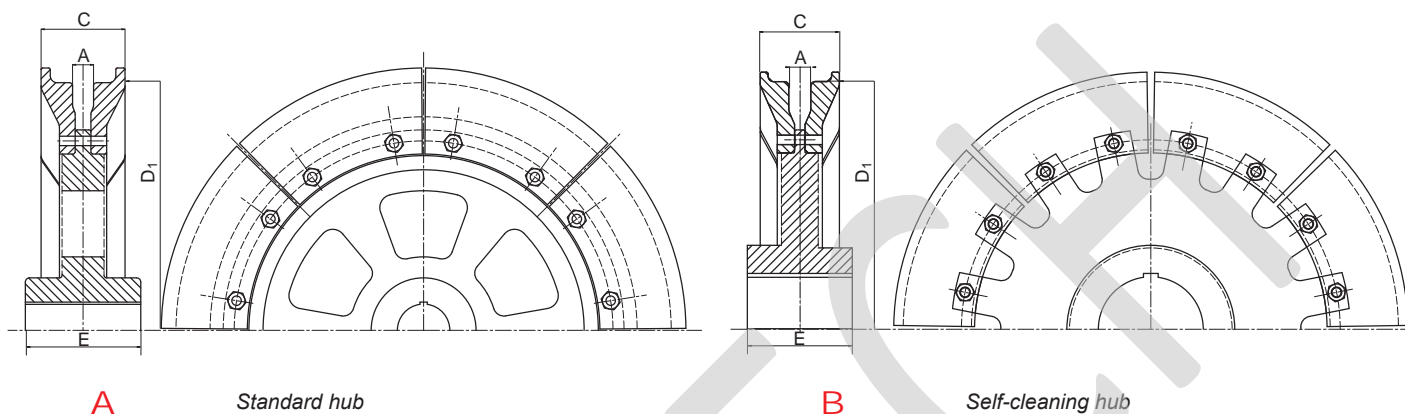

Code	Nominal diameter D (mm)	Chain diameter (mm)		No. of segment pairs	Dimensions mm				Mass (segments only) kg ≅
		DIN 764 DIN 766	LH		D ₁	A	C	E	
RLS 630/13 - RLS 630/14	630	13	14	8	615	19	82	140	65
RLS 630/16	630	16	-	8	615	22	85	140	67
RLS 630/18	630	18	-	8	615	24	87	140	69
RLS 630/20- RLS 630/19	630	20	19	8	615	27	92	160	70
RLS 630/23- RLS 630/22	630	23	22	8	615	29	94	160	70
RLS 710/16	710	16	16	8	690	22	90	150	75
RLS 710/18	710	18	-	8	690	24	92	150	78
RLS 710/20- RLS 710/19	710	20	19	8	690	27	95	160	80
RLS 710/23- RLS 710/22	710	23	22	8	690	32	100	160	82
RLS 710/26	710	26	-	8	690	34	102	160	84
RLS 800/20- RLS 800/19	800	20	19	8	780	27	107	160	95
RLS 800/23- RLS 800/22	800	23	22	8	780	30	110	160	98
RLS 800/26	800	26	-	8	780	34	115	160	100
RLS 900/23- RLS 900/22	900	23	22	8	875	30	130	190	155
RLS 900/26	900	26	26	8	875	34	135	190	160
RLS 900/30	900	30	-	8	875	42	140	190	165
RLS 1000/23	1000	23	-	10	970	30	135	200	210
RLS 1000/26	1000	26	26	10	970	34	139	200	220
RLS 1000/30	1000	30	30	10	970	42	145	200	230
RLS 1100/23	1100	23	-	10	1045	30	150	200	255
RLS 1100/26	1100	26	26	10	1045	34	154	200	255
RLS 1100/30	1100	30	30	10	1045	42	159	200	260
RLS 1100/36	1100	36	-	10	1045	46	165	200	270
RLS 1250/30 - RLS 1250/34	1250	30	30 / 34	12	1210	42	159	220	310
RLS 1250/36	1250	36	-	12	1210	46	165	220	320
RLS 1250/39	1250	39	-	12	1210	56	175	240	330

Segmented wheels for bucket elevators and conveyors, type RLSP

Plain segmented chain wheels for bucket elevators with chain according to DIN 764-DIN 766 and shackles according to DIN 5699-DIN 745, or chain type LH with special bucket attachments ATS or scraper attachments ALH/BLH.

Replaceable flat segments made of C45 steel with induction hardening, highly resistant to wear. Steel hub in welded steel fabrication with cleaning slots for material discharge. Bored and keyed according to the customer's request for shaft fixing with keyway or locking devices.

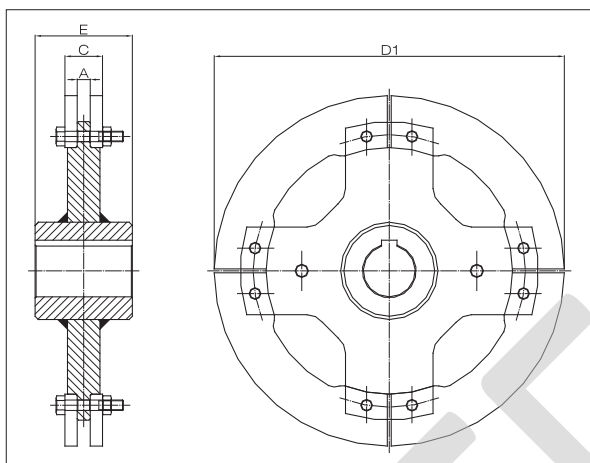

Code	Nominal diameter D (mm)	Pitch line diameter Dp (mm)	Chain diameter mm		Dimensions mm				Mass for wheel kg \approx
			DIN 764 DIN 766	LH	D1	A	C	E	
RLSP 450/13	450	453	13	-	440	20	60	120	100
RLSP 450/14	450	454	-	14	440	20	60	120	100
RLSP 450/16	450	456	16	-	440	22	62	120	100
RLSP 460/16	460	461	16	-	445	22	62	120	100
RLSP 500/13	500	503	13	-	490	20	60	120	110
RLSP 500/14	500	504	-	14	490	20	60	120	110
RLSP 500/16	500	506	16	-	490	22	62	120	110
RLSP 500/18	500	508	18	-	490	25	65	120	110
RLSP 540/13	540	543	13	-	530	20	60	120	120
RLSP 540/16	540	546	16	16	530	22	62	120	120
RLSP 560/16	560	561	16	16	545	22	62	120	130
RLSP 600/16	600	601	16	16	585	22	62	130	140
RLSP 630/16	630	631	16	16	615	22	62	130	145
RLSP 630/18	630	633	18	-	615	25	75	130	155
RLSP 630/19	630	634	-	19	615	25	75	130	155
RLSP 630/20	630	635	20	-	615	25	75	130	155
RLSP 630/22	630	632	-	22	610	28	78	130	160
RLSP 650/16	650	651	16	16	635	22	62	140	150
RLSP 650/18	650	653	18	-	635	25	75	140	170
RLSP 650/19	650	654	-	19	635	25	75	140	170
RLSP 650/22	650	657	-	22	635	27	77	140	175
RLSP 700/19	700	704	-	19	685	25	75	150	200
RLSP 700/22	700	702	-	22	680	28	78	150	200
RLSP 700/26	700	706	26	26	680	32	92	150	210
RLSP 800/22	800	802	-	22	780	28	78	150	240
RLSP 800/23	800	803	23	-	780	30	80	150	240
RLSP 800/26	800	801	26	26	775	32	92	150	250

Other diameters available on request

Toothed and pocket wheels

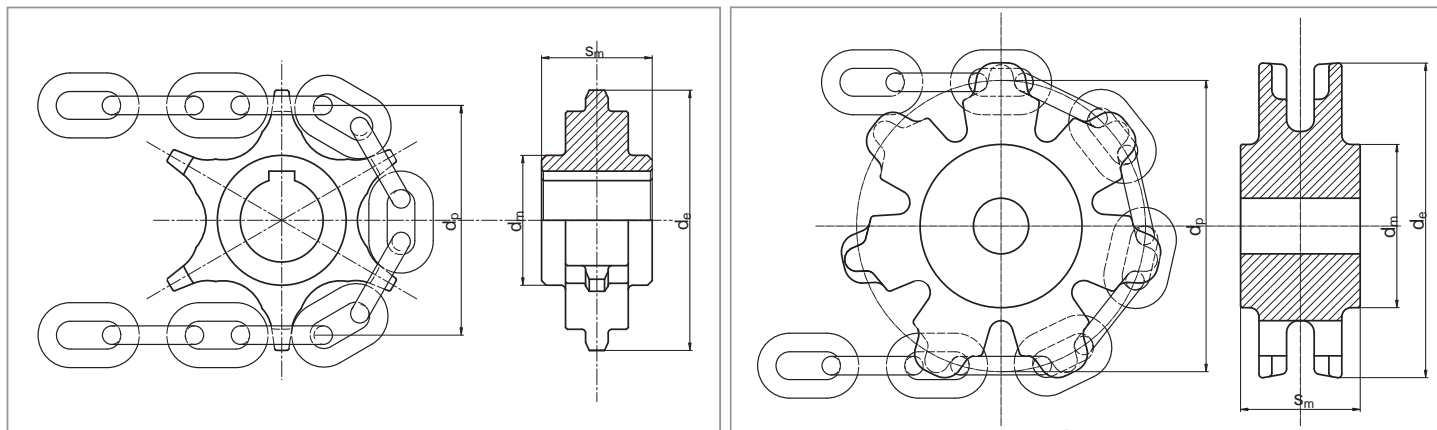

Toothed wheel	A	Pocket wheel	B
---------------	----------	--------------	----------

Wheel code	Type		Chain	d _p	d _e	d _m	s _m	∅ Max hole suggested	No. teeth	Mass kg ⁽¹⁾
	toothed	pocket								
RA10x35 - Z7		x	10x35 DIN 764	157	176	88	55	50	7	5.2
RD10x35 - Z6	x		10x35 DIN 764	136	140	70	60	45	6	2.1
RA13x45 - Z7		x	13x45 DIN 764	203	230	120	70	70	7	11.7
RD14x50 - Z8	x		14x50 LH	256	275	115	130	70	8	10 ⁽²⁾
RA16x56 - Z7		x	16x56 DIN 764	252	280	130	100	80	7	23
RD16x56 - Z6	x		16x56 DIN 764	217	229	130	100	80	6	11.5
RD16x56 - Z8	x		16x56 DIN 764	287	302	170	70	100	8	18
RD16x64 - Z8	x		16x64 LH	328	344	170	80	100	8	22
RA18x63 - Z6		x	18x63 DIN 764	244	274	168	100	95	6	24
RA18x63 - Z7		x	18x63 DIN 764	284	322	147	90	95	7	27
RA18x63 - Z9		x	18x63 DIN 764	363	390	200	120	130	9	58
RA20x70 - Z8		x	20x70 DIN 764	359	400	180	115	140	8	55
RA23x80 - Z8		x	23x80 DIN 764	411	450	200	135	140	8	85
RA22x86 - Z6		x	22x86 LH	333	400	160	130	135	6	89
RD22x86 - Z10	x		22x86 LH	550	585	230	160	-	10	24 ⁽²⁾

(1) for wheels with unmachined hole
 (2) toothed segment

Toothed and pocket wheels for chains DIN 764 and LH. They can be manufactured in one piece or two halves (assembled with transversal screws) for an easier disassembling. Made of GS-800 spheroidal graphite cast iron or special case hardened alloy steel for scrapers and conveyors; made of quenched alloy steel for traction conveyors and other applications.

