

Geared motors

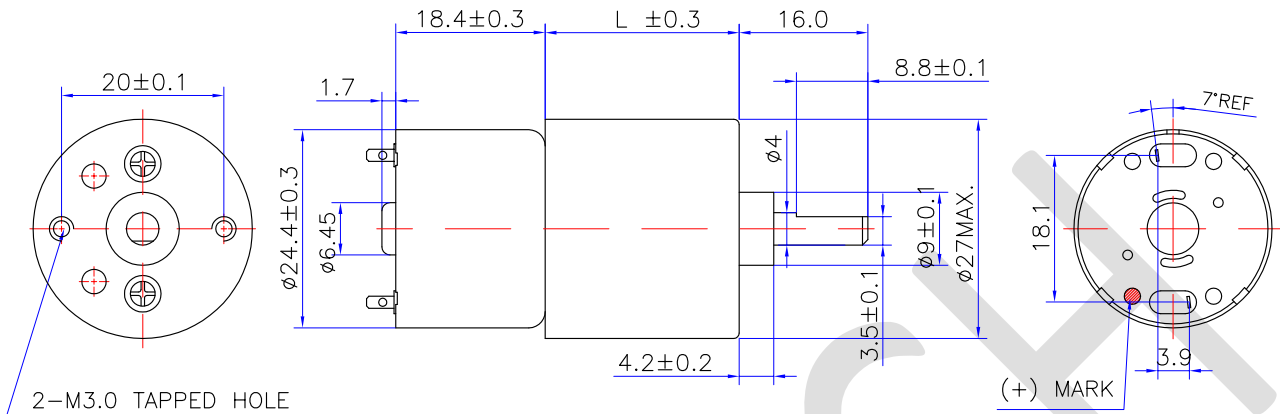

GEARED MOTORS

Serie CX.KR32-27GA



* CX.KR32-27GA932 + CX.KR32-27GA90 rotation CW

* CX.KR32-27GA188 + CX.KR32-27GA43 rotation CCW

Electric performances

Article	Ratio	L	Voltage (D.C.)		No Load		Rated Load			Max Torque
			Operating Range	Nominal Constant	Speed	Current	Speed	Current	Torque	
					rpm	mAmp	rpm	mAmp	N-cm	
CX.KR32-27GA I/43-07	43	24.20	3.0~12.0	6.0	57.7	≤20	39.5	≤50	1,25	5,00
CX.KR32-27GA I:43-07	43	24.20	3.0~12.0	12.0	120	≤30	84.7	≤85	2,45	8,00
CX.KR32-27GA I:90-07	90	24.20	3.0~12.0	6.0	28.5	≤25	24	≤60	2,45	6,00
CX.KR32-27GA I:90-07	90	24.20	3.0~12.0	12.0	58	≤30	44	≤70	2,95	12,25
CX.KR32-27GA I:188-07	188	24.20	3.0~12.0	6.0	13.5	≤25	8.1	≤60	4,90	12,25
CX.KR32-27GA I:188-07	188	24.20	3.0~12.0	12.0	28	≤30	20.5	≤80	7,35	27,50
CX.KR32-27GA I:392-07	392	24.20	3.0~12.0	6.0	6.3	≤25	3.9	≤60	9,80	25,50
CX.KR32-27GA I:392	392	24.20	3.0~12.0	12.0	13	≤30	9.5	≤80	14,50	50,00
CX.KR32-27GA I:819-07	819	27.70	3.0~12.0	6.0	3	≤25	2.1	≤50	11,70	29,50
CX.KR32-27GA I:819-07	819	27.70	3.0~12.0	12.0	6.3	≤30	5.1	≤65	19,50	50,00

General Tolerances ± 15%

do not apply a higher load to the maximum shown torque

General Information

- Direction of rotation according to polarity
- Working temperature: -5°C ~ +60°C
- Operation relative humidity 20%~85% RH
- Housing in zamac die-casting
- Pinions and gears in sintered steel
- Possibility to deliver the geared motors with hall sensor magnetic encoder
- Possibility to customize the electric specification according the customer requirement.

GEARED MOTORS

Serie CX.KR37-27GA

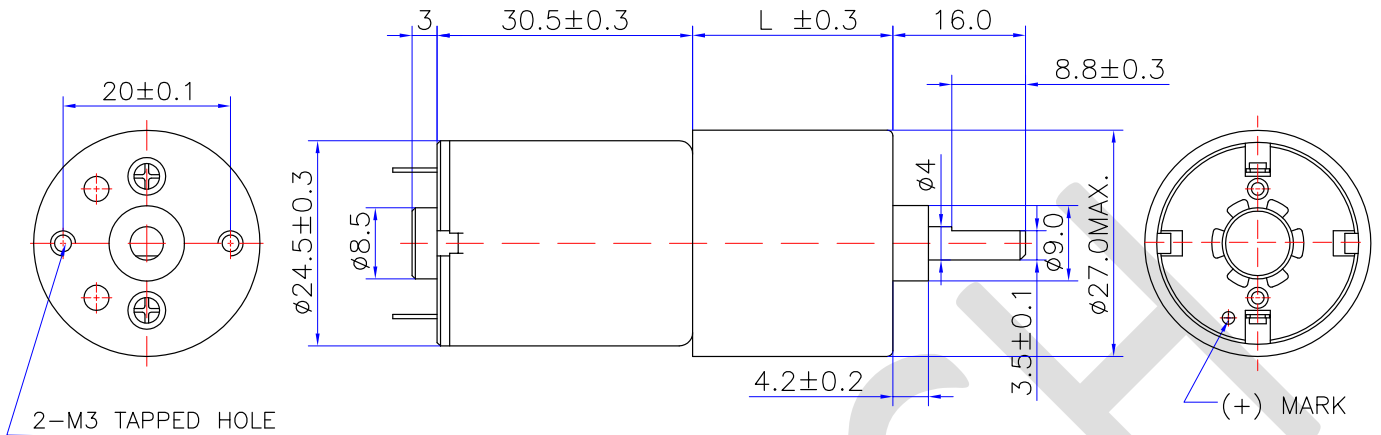

* CX.KR32-27GA932 + CX.KR32-27GA90 rotation CCW

* CX.KR32-27GA188 + CX.KR32-27GA43 rotation CW

Electric performances

Article	Ratio	L	Voltage (D.C.)		No Load		Rated Load			Max Torque
			Operating Range	Nominal Constant	Speed	Current	Speed	Current	Torque	
					rpm	mAmp	rpm	mAmp	N-cm	
CX.KR37-27GA 1/43-11	43	24.20	4.5~24.0	12.0	80.0	≤35	64.0	≤120	5	25
CX.KR37-27GA 1:90-11	90	24.20	4.5~24.0	12.0	39.0	≤35	31.3	≤120	7	30
CX.KR37-27GA 1: 188-11	188	24.20	4.5~24.0	12.0	19.0	≤35	14.2	≤140	20	60
CX.KR37-27GA 1: 392-11	392	24.20	4.5~24.0	12.0	9	≤35	7.5	≤110	24	60
CX.KR37-27GA 1: 43-08	43	24.20	4.5~24.0	12.0	60.0	≤25	40.0	≤75	5	15
CX.KR37-27GA 1: 90-08	90	24.20	4.5~24.0	12.0	27	≤25	14.7	≤75	10	21
CX.KR37-27GA 1: 188-08	188	24.20	4.5~24.0	12.0	12.8	≤25	8.6	≤75	14	50
CX.KR37-27GA 1: 392-08	392	24.20	4.5~24.0	6.0	3	≤20	2.3	≤35	10	50
CX.KR37-27GA 1: 392-08	392	24.20	4.5~24.0	12.0	6	≤20	4.5	≤60	24	60
CX.KR37-27GA 1: 392-08	392	24.20	4.5~24.0	24.0	12.5	≤35	10.0	≤95	39	60

General Tollerances ± 15%

do not apply a higher load to the maximum shown torque

General Information

- Direction of rotation according to polarity
- Working temperature: -5°C ~ +60°C
- Operation relative humidity 20%~85% RH
- Housing in zamac die-casting
- Pinions and gears in sintered steel
- Possibility to deliver the geared motors with hall sensor magnetic encoder
- Possibility to customize the electric specification according the customer requirement.

GEARED MOTORS

Serie CX.KR50-33G

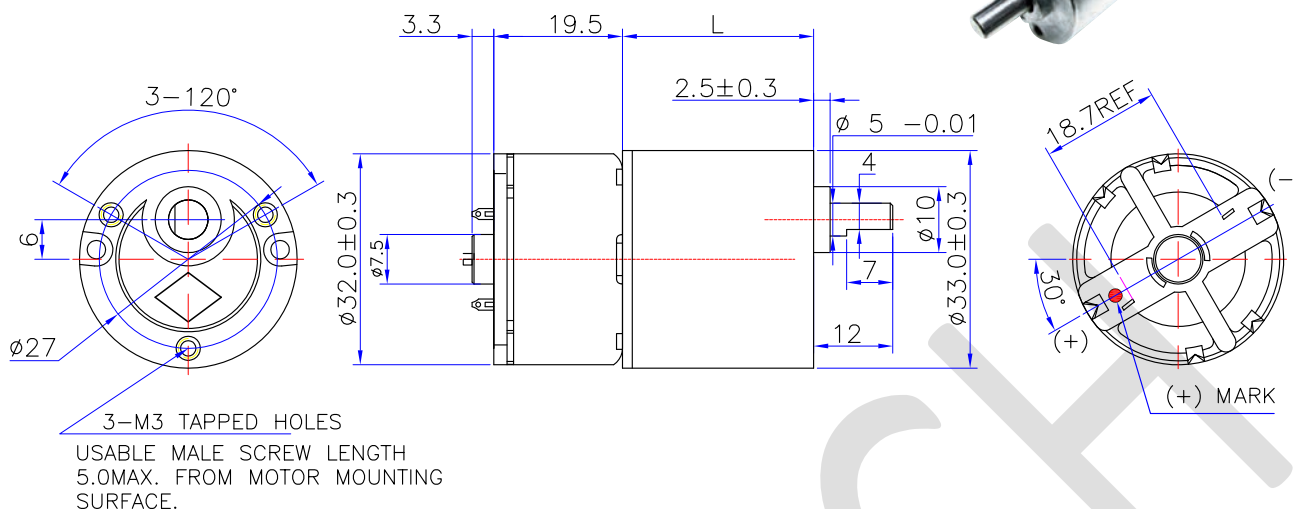

Electric performances

Article	Ratio	L	Voltage (D.C.)		No Load		Rated Load			Max Torque
			Operating Range	Nominal Constant	Speed	Current	Speed	Current	Torque	
					rpm	mAmp	rpm	mAmp	N-cm	
CX.KR50-33GG-10	8	20,0	4.5~15.0	12.0	470	≤25	348	≤100	1,45	5,90
CX.KR50-33GF-10	20	20,0	4.5~15.0	12.0	192	≤30	142	≤100	2,45	11,75
CX.KR50-33GE-10	50	20,0	4.5~15.0	12.0	75	≤30	55	≤100	3,35	34,50
CX.KR50-33GD-10	125	24,5	4.5~15.0	12.0	30	≤30	23	≤100	12,30	50,00
CX.KR50-33GC-10	312.5	24,5	4.5~15.0	12.0	12	≤30	9	≤100	24,50	93,20
CX.KR50-33GB-10	781	29,0	4.5~15.0	12.0	4.8	≤30	3,8	≤90	50,00	118,00
CX.KR50-33GA-10	1953	29,0	4.5~15.0	12.0	2	≤30	1,6	≤60	50,00	127,50
CX.KR50-33GC-07	312.5	24,5	6.0~24.0	12.0	10	≤25	6,7	≤70	24,50	74,50
CX.KR50-33GC-07	312.5	24,5	6.0~24.0	24.0	21	≤40	17,6	≤90	24,50	127,50
CX.KR50-33GA-07	1953	29,0	6.0~24.0	12.0	1,5	≤25	1,3	≤50	29,50	98,00
CX.KR50-33GA-07	1953	29,0	6.0~24.0	24.0	3	≤40	2,28	≤70	50,00	147,00

General Tolerances $\pm 15\%$

do not apply a higher load to the maximum shown torque

General Information

- Direction of rotation according to polarity
- Working temperature: -5°C ~ +60°C
- Operation relative humidity 20%~85% RH
- Housing in zamac die-casting
- Pinions and gears in sintered steel
- Possibility to deliver the geared motors with hall sensor magnetic encoder
- Possibility to customize the electric specification according to the customer requirement.

GEARED MOTORS

Serie CX.KC38-33G

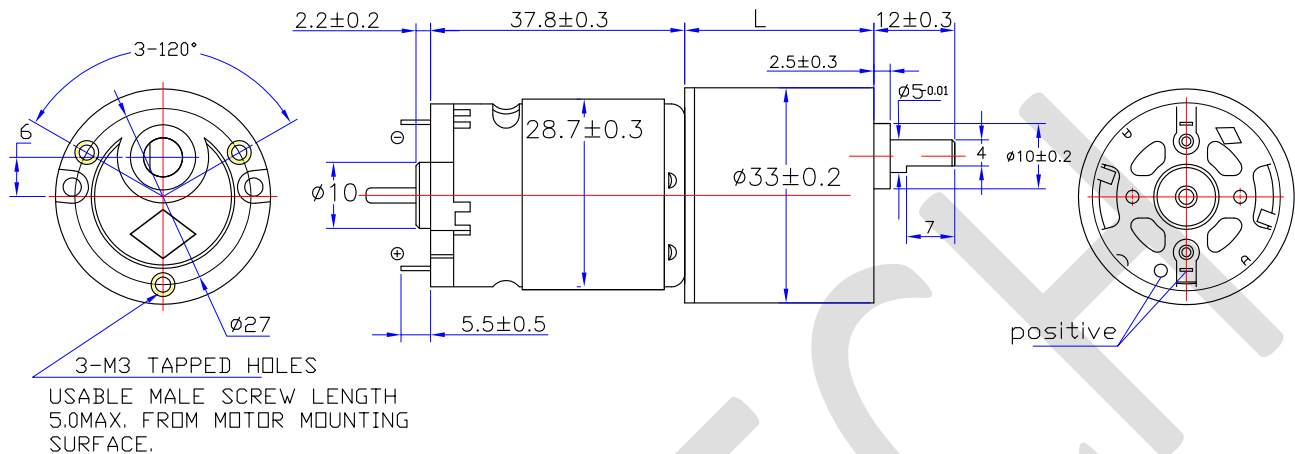

Electric performances

Article	Ratio	L mm	Voltage (D.C.)		No Load		Rated Load			Max Torque N-cm
			Operating Range	Nominal Constant	Speed	Current	Speed	Current	Torque	
					rpm	mAmp	rpm	mAmp	N-cm	
CX.KC38-33GG	8	20,0	6.0~30.0	12.0	810	≤190	650	≤700	7,80	24,50
				24.0		≤90		≤400		
CX.KC38-33GF	20	20,0	6.0~30.0	12.0	325	≤190	245	≤700	9,80	34,30
				24.0		≤90		≤400		
CX.KC38-33GE	50	20,0	6.0~30.0	12.0	130	≤190	100	≤700	19,50	58,80
				24.0		≤90		≤400		
CX.KC38-33GD	125	24,5	6.0~30.0	12.0	46	≤190	40	≤700	29,40	88,25
				24.0		≤90		≤400		
CX.KC38-33GC	312.5	24,5	6.0~30.0	12.0	20	≤190	15	≤700	34,30	127,50
				24.0		≤80		≤400		
CX.KC38-33GB	781	29,0	6.0~30.0	12.0	8	≤190	6	≤600	44,15	127,50
				24.0		≤80		≤300		
CX.KC38-33GA	1953	29,0	6.0~30.0	12.0	3	≤170	2	≤600	50,0	157,10
				24.0		≤80		≤300		

General Tollerances ± 15%

do not apply a higher load to the maximum shown torque

General Information

- Direction of rotation according to polarity
- Working temperature: -5°C ~ +60°C
- Operation relative humidity 20%~85% RH
- Housing in zamac die-casting
- Pinions and gears in sintered steel
- Possibility to deliver the geared motors with hall sensor magnetic encoder
- Possibility to customize the electric specification according to the customer requirement.

GEARED MOTORS

Serie CX.37GB

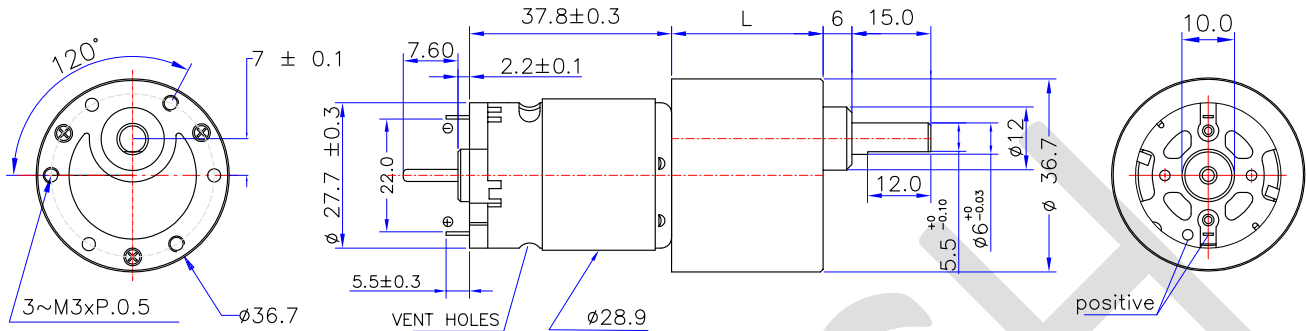

Electric performances

Article	Ratio	L mm	Voltage (D.C.)		No Load		Rated Load			Max Torque N-cm
			Operating Range	Nominal Constant	Speed	Current	Speed	Current	Torque	
					rpm	mAmp	rpm	mAmp	N-cm	
CX.37GB.10	10	19.50	6.0~30.0	12.0	600	≤160	521	≤700	8	20
				24.0		≤80		≤400		
CX.37GB.30	30	22.00	6.0~30.0	12.0	200	≤160	175	≤700	12	30
				24.0		≤80		≤400		
CX.37GB.50	50	24.50	6.0~30.0	12.0	120	≤160	105	≤700	20	40
				24.0		≤80		≤400		
CX.37GB.75	75	24.50	6.0~30.0	12.0	80	≤160	70	≤700	30	60
				24.0		≤80		≤400		
CX.37GB.100	100	24.50	6.0~30.0	12.0	65	≤160	52	≤700	40	80
				24.0		≤80		≤400		
CX.37GB.120	120	27.00	6.0~30.0	12.0	54	≤160	42	≤600	45	120
				24.0		≤80		≤300		
CX.37GB.150	150	27.00	6.0~30.0	12.0	43	≤160	35	≤600	51	120
				24.0		≤80		≤300		
CX.37GB.200	200	27.00	6.0~30.0	12.0	32	≤160	26	≤600	68	120
				24.0		≤80		≤300		
CX.37GB.250	250	27.00	6.0~30.0	12.0	26	≤160	21	≤500	86	120
				24.0		≤80		≤200		
CX.37GB.500	500	29.50	6.0~30.0	12.0	13	≤160	10	≤500	150	160
				24.0		≤80		≤200		
CX.37GB.1000	1000	29.50	6.0~30.0	12.0	6	≤160	5	≤500	160	180
				24.0		≤80		≤200		
CX.37GB.3000	3000	32.00	6.0~30.0	12.0	2	≤160	1,5	≤500	200	200
				24.0		≤80		≤200		

General Tolerances ± 15%

do not apply a higher load to the maximum shown torque

General Information

- Direction of rotation according to polarity
- Operation relative humidity 20%~85% RH
- Radial load ≤ 1KgF (10mm from the flange)
- Pinion in brass
- Backlash, at no load ≤ 2°
- Possibility to deliver the geared motors with hall sensor magnetic encoder

- Working temperature: -10°C ~ +60°C
- Gearbox with sleeve bearing
- Shaft axial load ≤ 0.7KgF
- Metal cutting gears
- Shaft press fit force, max ≤ 20KgF
- Possibility to customize the electric specification according to the customer requirement.

GEARED MOTORS

Serie CX.37GBS

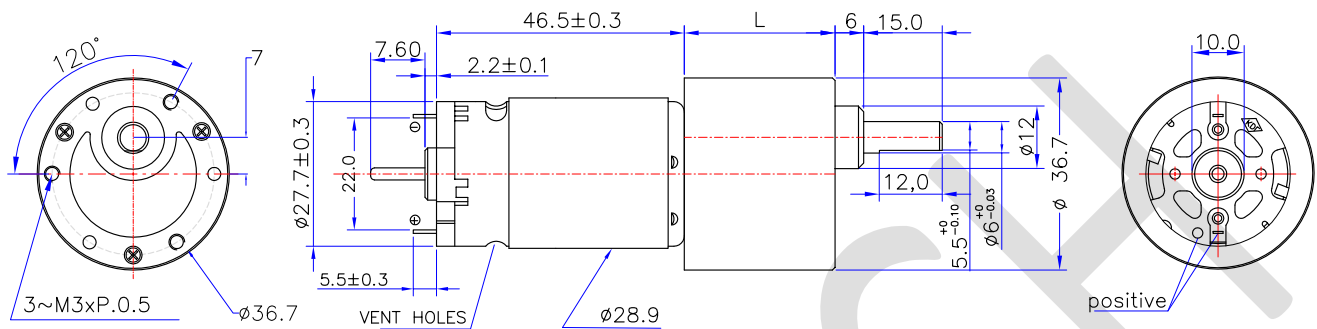
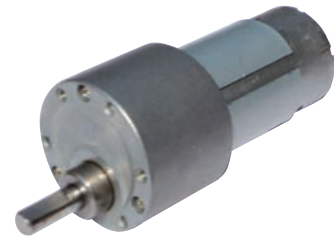

Electric performances

Article	Ratio	L mm	Voltage (D.C.)		No Load		Rated Load			Max Torque N-cm
			Operating Range	Nominal Constant	Speed	Current	Speed	Current	Torque	
					rpm	mAmp	rpm	mAmp	N-cm	
CX.37GBS.10	10	19.50	6.0~30.0	12.0	610	≤160	530	≤1200	10	20
				24.0		≤80		≤600		
CX.37GBS.30	30	22.00	6.0~30.0	12.0	210	≤160	190	≤1200	18	40
				24.0		≤80		≤600		
CX.37GBS.50	50	24.50	6.0~30.0	12.0	130	≤160	115	≤1200	30	60
				24.0		≤80		≤600		
CX.37GBS.75	75	24.50	6.0~30.0	12.0	90	≤160	75	≤1200	45	80
				24.0		≤80		≤600		
CX.37GBS.100	100	24.50	6.0~30.0	12.0	65	≤160	55	≤900	60	90
				24.0		≤80		≤400		
CX.37GBS.120	120	27.00	6.0~30.0	12.0	55	≤160	43	≤900	70	120
				24.0		≤80		≤400		
CX.37GBS.150	150	27.00	6.0~30.0	12.0	43	≤160	38	≤900	80	120
				24.0		≤80		≤400		
CX.37GBS.200	200	27.00	6.0~30.0	12.0	33	≤160	28	≤900	100	150
				24.0		≤80		≤400		
CX.37GBS.250	250	27.00	6.0~30.0	12.0	27	≤160	22	≤900	130	160
				24.0		≤80		≤400		
CX.37GBS.500	500	29.50	6.0~30.0	12.0	13	≤160	11	≤900	150	180
				24.0		≤80		≤400		
CX.37GBS.1000	1000	29.50	6.0~30.0	12.0	6	≤160	5	≤900	160	190
				24.0		≤80		≤400		
CX.37GBS.3000	3000	32.00	6.0~30.0	12.0	2	≤160	1,5	≤900	200	210
				24.0		≤80		≤400		

General Tolerances $\pm 15\%$

do not apply a higher load to the maximum shown torque

General Information

- Direction of rotation according to polarity
- Operation relative humidity 20%~85% RH
- Radial load $\leq 1\text{Kg}$ (10mm from the flange)
- Pinion in brass
- Backlash, at no load $\leq 2^\circ$
- Possibility to deliver the geared motors with hall sensor magnetic encoder
- Possibility to customize the electric specification according to the customer requirement.
- Working temperature: $-10^\circ\text{C} \sim +60^\circ\text{C}$
- Gearbox with sleeve bearing
- Shaft axial load $\leq 0.7\text{Kg}$
- Metal cutting gears
- Shaft press fit force, max $\leq 20\text{Kg}$

GEARED MOTORS

Serie CX.37GB3

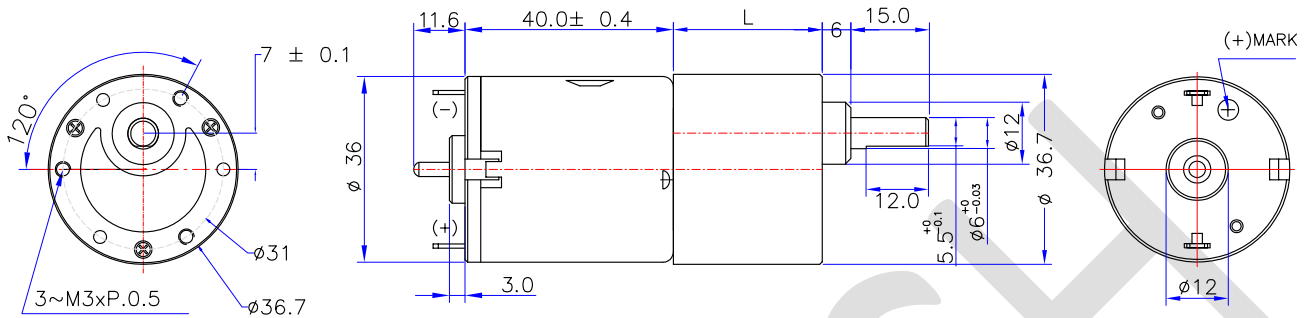

Electric performances

Article	Ratio	L	Voltage (D.C.)		No Load		Rated Load			Max Torque
			Operating Range	Nominal Constant	Speed	Current	Speed	Current	Torque	
					rpm	mAmp	rpm	mAmp	N-cm	
CX.37GB3.10	10	19.50	6.0~30.0	12.0	440	≤160	350	≤800	10	30
				24.0		≤80		≤450		
CX.37GB3.30	30	22.00	6.0~30.0	12.0	146	≤160	116	≤800	28	50
				24.0		≤80		≤450		
CX.37GB3.50	50	24.50	6.0~30.0	12.0	88	≤160	69	≤800	40	70
				24.0		≤80		≤450		
CX.37GB3.75	75	24.50	6.0~30.0	12.0	58	≤160	46	≤800	65	100
				24.0		≤80		≤450		
CX.37GB3.100	100	24.50	6.0~30.0	12.0	44	≤160	34	≤800	85	150
				24.0		≤80		≤450		
CX.37GB3.120	120	27.00	6.0~30.0	12.0	36	≤160	29	≤800	90	150
				24.0		≤80		≤450		
CX.37GB3.150	150	27.00	6.0~30.0	12.0	29	≤160	23	≤800	115	150
				24.0		≤80		≤450		
CX.37GB3.200	200	27.00	6.0~30.0	12.0	22	≤160	17	≤800	150	180
				24.0		≤80		≤450		
CX.37GB3.250	250	27.00	6.0~30.0	12.0	17	≤160	13	≤800	160	180
				24.0		≤80		≤450		
CX.37GB3.500	500	29.50	6.0~30.0	12.0	8	≤160	6	≤700	170	180
				24.0		≤80		≤400		
CX.37GB3.1000	1000	29.50	6.0~30.0	12.0	4	≤160	3	≤700	180	190
				24.0		≤80		≤400		
CX.37GB3.3000	3000	32.00	6.0~30.0	12.0	1,5	≤160	1	≤700	200	210
				24.0		≤80		≤400		

General Tolerances ± 15%

do not apply a higher load to the maximum shown torque

General Information

- Direction of rotation according to polarity
- Operation relative humidity 20%~85% RH
- Radial load ≤ 1Kgf (10mm from the flange)
- Pinion in brass
- Backlash, at no load ≤ 2°
- Possibility to deliver the geared motors with hall sensor magnetic encoder
- Possibility to customize the electric specification according to the customer requirement.
- Working temperature: -10°C ~ +60°C
- Gearbox with sleeve bearing
- Shaft axial load ≤ 0.7Kgf
- Metal cutting gears
- Shaft press fit force, max ≤ 20Kgf

GEARED MOTORS

Serie CX.KC38-3625G

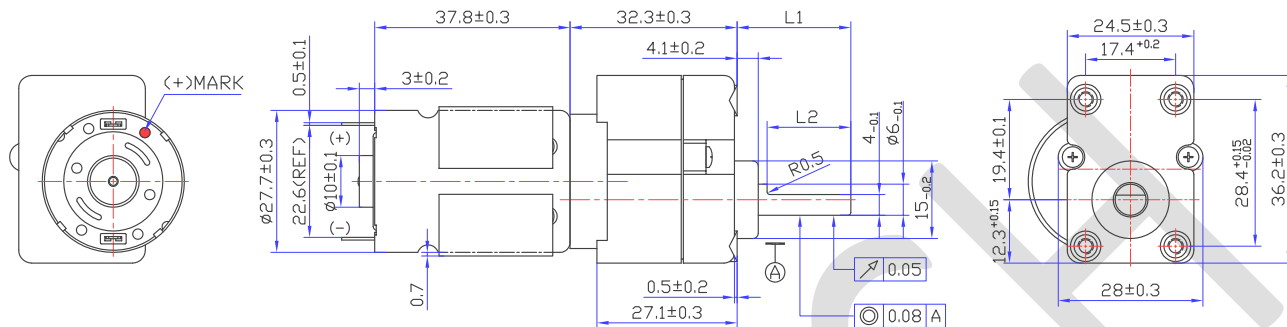

Model	Gear Ratio	L1 mm	L2 mm
CX.38-3625G109	1:109	22±0.5	16.2±0.2
CX.38-3625G43	1:43	19.6±0.5	13.8±0.2
CX.38-3625G31	1:31	22±0.5	16.2±0.2

Electric performances

Article	Ratio	L	Voltage (D.C.)		No Load		Rated Load			Max Torque
			Operating Range	Nominal Constant	Speed	Current	Speed	Current	Torque	
					rpm	mAmp	rpm	mAmp	N-cm	
CX.38-3625G10	10	19.6	6.0~30.0	12,0	540	≤150	420	≤700	10	45
				24,0		≤150		≤400		
CX.38-3625G31	31	22.0	6.0~30.0	12,0	160	≤150	120	≤600	20	65
				24,0		≤100		≤250		
CX.38-3625G43	43	19.6	6.0~30.0	12,0	129	≤150	99	≤600	30	100
				24,0		≤100		≤400		
CX.38-3625G109	109	22.0	6.0~30.0	12,0	65	≤150	56	≤600	50	100
				24,0		≤100		≤400		

General Tollerances ± 15%

do not apply a higher load to the maximum shown torque

General Information

- Direction of rotation according to polarity
- Cutting gears
- Possibility to deliver the geared motors with hall sensor magnetic encoder
- Possibility to customize the electric specification according to the customer requirement.

GEARED MOTORS

Serie CX.48GR

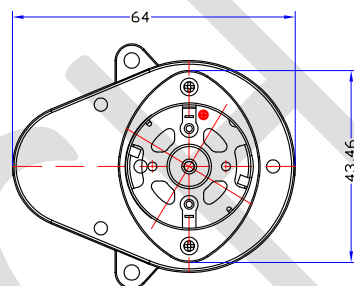
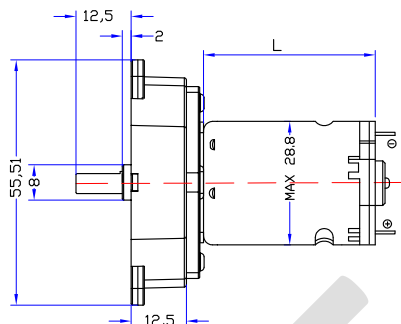
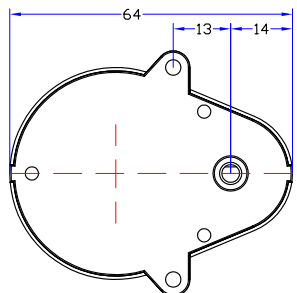
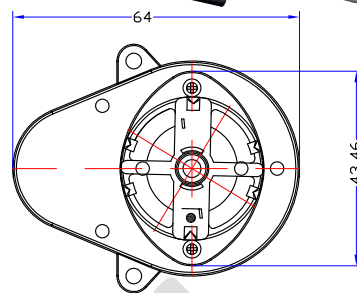
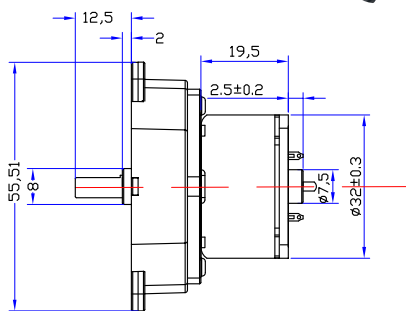
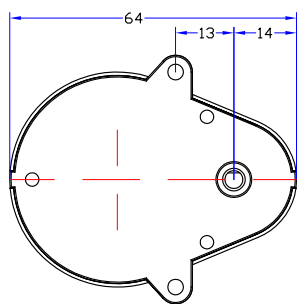
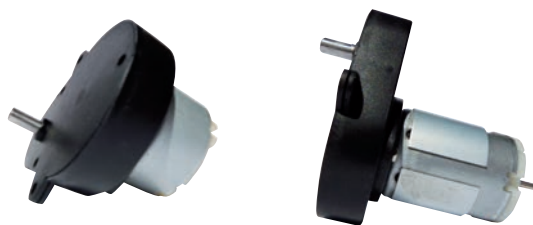

Electric performances

Article	Ratio	L mm	Voltage (D.C.)		No Load		Rated Load			Max Torque N-cm
			Operating Range	Nominal Constant	Speed	Current	Speed	Current	Torque	
					rpm	mAmp	rpm	mAmp	N-cm	
CX.48GR5.100	100	19.50	6.0~24.0	6.0	38	≤50	31	≤150	15	50
CX.48GR5.200	200	19.50	6.0~24.0	6.0	19	≤50	15	≤150	30	80
CX.48GR5.300	300	19.50	6.0~24.0	6.0	12	≤50	10	≤150	50	100
CX.48GR6.100	100	32.50	6.0~30.0	6.0	38	≤50	31	≤150	18	80
CX.48GR6.200	200	32.50	6.0~30.0	6.0	19	≤50	15	≤150	50	100
CX.48GR6.300	300	37.80	6.0~30.0	6.0	12	≤50	10	≤150	70	150
CX.48GR8.100	100	37.80	6.0~30.0	12.0	42	≤100	33	≤300	70	150
CX.48GR8.200	200	37.80	6.0~30.0	12.0	21	≤100	16.5	≤300	90	200
CX.48GR8.300	300	37.80	6.0~30.0	12.0	14	≤100	11	≤300	120	200

General Tolerances ± 15%

do not apply a higher load to the maximum shown torque

General Information

- Direction of rotation according to polarity
- Plastic (POM) gears

-Possibility to customize the electric specification according the customer requirement.

GEARED MOTORS

Serie CX.MV

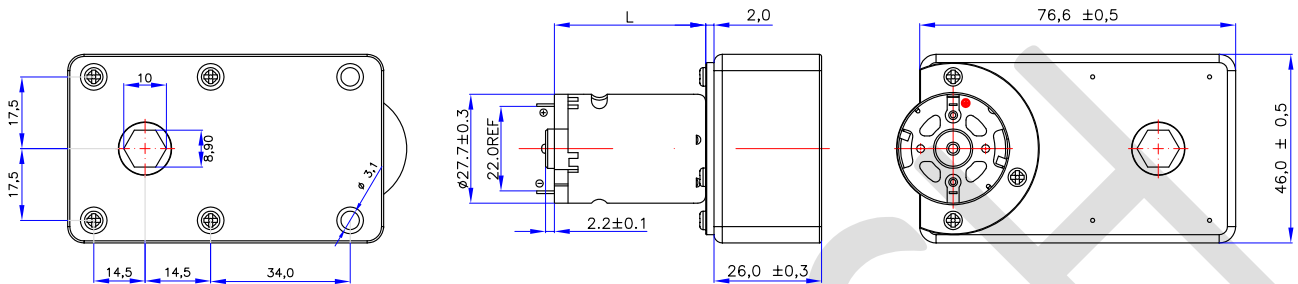
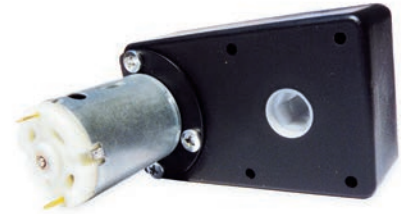

Electric performances

Article	Ratio	L mm	Voltage (D.C.)		No Load		Rated Load			Max Torque N-cm
			Operating Range	Nominal Constant	Speed	Current	Speed	Current	Torque	
					rpm	mAmp	rpm	mAmp	N-cm	
CX.MV6.88	88	32.50	6.0~30.0	24.0	110	≤ 150	87	≤ 400	25	100
CX.MV6.133	133	32.50	6.0~30.0	24.0	74	≤ 150	58	≤ 400	40	100
CX.MV8.88.150	88	37.80	6.0~30.0	24.0	110	≤ 150	85	≤ 450	50	200
CX.MV8.133.150	133	37.80	6.0~30.0	24.0	74	≤ 150	56	≤ 450	80	200
CX.MV8.88.93	88	37.80	6.0~30.0	24.0	155	≤ 200	130	≤ 850	70	200
CX.MV8.133.93	133	37.80	6.0~30.0	24.0	101	≤ 200	83	≤ 850	100	200
CX.MV8.88.320	88	37.80	6.0~30.0	24.0	47	≤ 80	37	≤ 200	26	120
CX.MV8.133.320	133	37.80	6.0~30.0	24.0	31	≤ 80	24	≤ 200	40	120
CX.MV9.88	88	46.50	6.0~30.0	24.0	112	≤ 200	96	≤ 700	80	200
CX.MV9.133	133	46.50	6.0~30.0	24.0	74	≤ 80	63	≤ 700	100	200

General Tolerances $\pm 15\%$

do not apply a higher load to the maximum shown torque

General Information

- Direction of rotation according to polarity
- Operation relative humidity 20%~60% RH
- Plastic (POM) gears
- Possibility to deliver the geared motors with hall sensor magnetic encoder
- Possibility to customize the electric specification according the customer requirement.
- Working temperature: -10°C ~ +60°C
- Gearbox with sleeve bearing

PLANETARY GEARED MOTORS Serie CX.16GBE

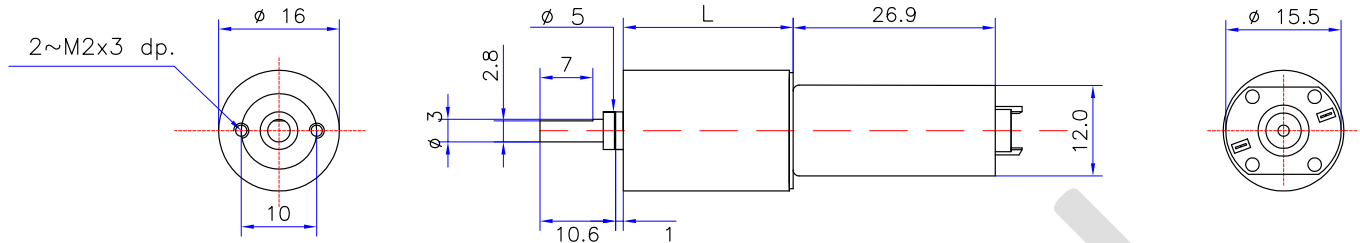

Electric performances

Article	Ratio	L mm	Voltage (D.C.)		No Load		Rated Load			Max Torque N-cm
			Operating Range	Nominal Constant	Speed	Current	Speed	Current	Torque	
					rpm	mAmp	rpm	mAmp	N-cm	
CX.16GBE.14	14	18.05	3.0~24.0	12.0	569	≤110	430	≤180	0,60	14,70
				24.0	964	≤100	760	≤150	0,85	14,70
CX.16GBE.19	19	18.05	3.0~24.0	12.0	416	≤110	315	≤180	0,80	14,70
				24.0	710	≤100	555	≤150	1,18	14,70
CX.16GBE.29	29	21.70	3.0~24.0	12.0	274	≤110	205	≤180	0,98	19,60
				24.0	463	≤100	365	≤150	1,65	19,60
CX.16GBE.62	62	21.70	3.0~24.0	12.0	130	≤110	101	≤180	2,15	19,60
				24.0	219	≤100	165	≤150	3,25	19,60
CX.16GBE.84	84	21.70	3.0~24.0	12.0	95	≤110	74	≤180	2,95	19,60
				24.0	160	≤100	130	≤150	4,45	19,60
CX.16GBE.104	104	21.70	3.0~24.0	12.0	77	≤110	60	≤180	3,75	19,60
				24.0	130	≤100	105	≤150	5,50	19,60
CX.16GBE.128	128	25.35	3.0~24.0	12.0	63	≤110	48	≤180	4,50	19,60
				24.0	105	≤100	80	≤150	6,80	24,50
CX.16GBE.157	157	25.35	3.0~24.0	12.0	51	≤110	39	≤180	5,40	24,50
				24.0	85	≤100	65	≤150	8,35	24,50
CX.16GBE.231	231	25.35	3.0~24.0	12.0	35	≤110	27	≤180	6,85	24,50
				24.0	58	≤100	47	≤150	9,80	29,50
CX.16GBE.316	316	25.35	3.0~24.0	12.0	25	≤110	20	≤180	9,30	24,50
				24.0	42,7	≤100	32	≤150	13,70	29,50
CX.16GBE.455	455	25.35	3.0~24.0	12.0	17,6	≤110	14	≤180	13,25	24,50
				24.0	29,6	≤100	22	≤150	19,60	44,10
CX.16GBE.690	690	29.00	3.0~24.0	12.0	11,6	≤110	9	≤150	20,60	24,50
				24.0	19,5	≤100	15	≤140	29,50	44,10
CX.16GBE.1014	1014	29.00	3.0~24.0	12.0	7,9	≤110	6,9	≤150	23,50	29,50
				24.0	13,3	≤100	10	≤130	29,50	49,00
CX.16GBE.1621	1621	29.00	3.0~24.0	12.0	4,9	≤110	4,4	≤150	29,50	44,10
				24.0	8,3	≤100	7	≤130	29,50	49,00
CX.16GBE.3027	3027	29.00	3.0~24.0	12.0	2,6	≤110	2,5	≤150	29,50	44,10
				24.0	4,5	≤100	4,1	≤130	29,50	49,00

General Tolerances ± 15%

do not apply a higher load to the maximum shown torque

General Information

- Direction of rotation according to polarity
- Operation relative humidity 20%~85% RH
- Radial load ≤ 0.5Kgf (10mm from the flange)
- Backlash, at no load ≤ 3°
- Possibility to deliver the geared motors with hall sensor magnetic encoder
- Working temperature: -10°C ~ +60°C
- Gearbox with sleeve bearing
- Shaft axial load ≤ 0.5Kgf
- Shaft press fit force, max ≤ 1.5Kgf

PLANETARY GEARED MOTORS Serie CX.22GBES

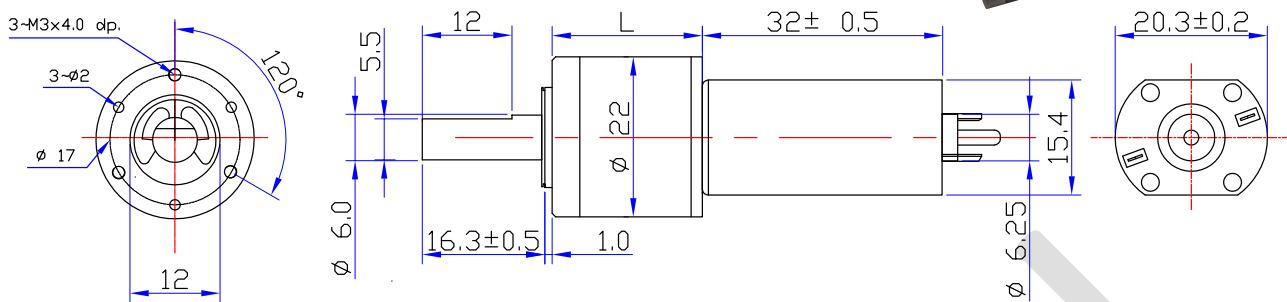

Electric performances

Article	Ratio	L mm	Voltage (D.C.)		No Load		Rated Load			Max Torque N-cm
			Operating Range	Nominal Constant	Speed	Current	Speed	Current	Torque	
					rpm	mAmp	rpm	mAmp	N-cm	
CX.22GBES.18	18	29.50	3.0~24.0	12.0	444	≤110	375	≤240	2,50	30,0
				24.0	500	≤100	414	≤150		
CX.22GBES.25	25	29.50	3.0~24.0	12.0	320	≤110	260	≤240	3,50	30,0
				24.0	360	≤100	290	≤150		
CX.22GBES.66	66	35.70	3.0~24.0	12.0	121	≤110	101	≤240	8,10	40,0
				24.0	136	≤100	110	≤150		
CX.22GBES.90	90	35.70	3.0~24.0	12.0	88	≤110	74	≤240	11,00	40,0
				24.0	100	≤100	82	≤150		
CX.22GBES.110	110	35.70	3.0~24.0	12.0	72	≤110	60	≤240	13,50	40,0
				24.0	81,8	≤100	66	≤150		
CX.22GBES.136	136	35.70	3.0~24.0	12.0	58	≤110	48	≤240	16,50	40,0
				24.0	66	≤100	53	≤150		
CX.22GBES.246	246	41.90	3.0~24.0	12.0	32	≤110	26	≤240	25,00	50,0
				24.0	36,5	≤100	29	≤150		
CX.22GBES.336	336	41.90	3.0~24.0	12.0	23	≤110	19	≤240	36,00	60,0
				24.0	26,7	≤100	21	≤150		
CX.22GBES.484	484	41.90	3.0~24.0	12.0	16,5	≤110	13,8	≤240	50,00	100,0
				24.0	18,5	≤100	15,3	≤150		
CX.22GBES.597	597	41.90	3.0~24.0	12.0	13,4	≤110	11,5	≤220	50,00	100,0
				24.0	15	≤100	12,7	≤150		
CX.22GBES.735	735	41.90	3.0~24.0	12.0	10,5	≤110	9,5	≤220	50,00	100,0
				24.0	12,2	≤100	10,5	≤140		
CX.22GBES.1079	1079	48.10	3.0~24.0	12.0	7,4	≤110	6,7	≤200	60,00	150,0
				24.0	8	≤100	7,4	≤140		
CX.22GBES.1475	1475	48.10	3.0~24.0	12.0	5,4	≤110	5	≤200	60,00	150,0
				24.0	6,1	≤100	5,5	≤130		
CX.22GBES.2124	2124	48.10	3.0~24.0	12.0	3,7	≤110	3,4	200	60,00	150,0
				24.0	4,2	≤100	3,9	≤120		
CX.22GBES.3698	3698	48.10	3.0~24.0	12.0	2	≤110	1,8	≤200	60,00	150,0
				24.0	2,2	≤100	1,9	≤120		

General Tollerances ± 15%

do not apply a higher load to the maximum shown torque

General Information

- Direction of rotation according to polarity
- Operation relative humidity 20%~85% RH
- Radial load ≤ 1.0Kgf (10mm from the flange)
- Backlash, at no load ≤ 2.5°
- Possibility to deliver the geared motors with hall sensor magnetic encoder

- Working temperature: -10°C ~ +60°C
- Gearbox with sleeve bearing
- Shaft axial load ≤ 0.7Kgf
- Shaft press fit force, max ≤ 6Kgf

PLANETARY GEARED MOTORS Serie CX.30GBE

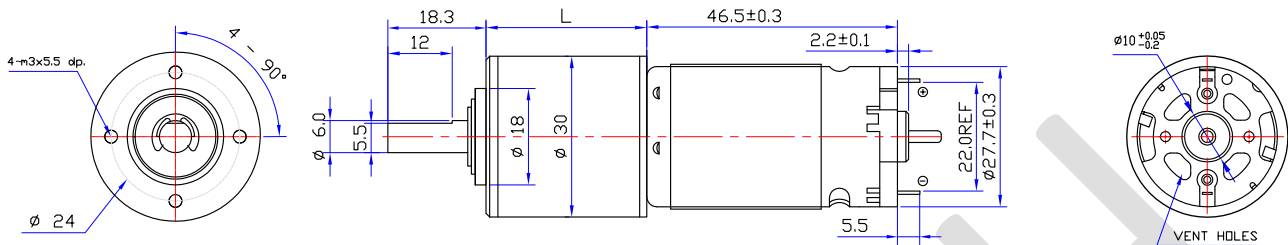

Electric performances

Article	Ratio To:1	L mm	Voltage (D.C.)		No Load		Rated Load			Max Torque N-cm
			Operating Range	Nominal Constant	Speed	Current	Speed	Current	Torque	
					rpm	mAmp	rpm	mAmp	N-cm	
CX.30GBE.5	5	23.6	6.0~24.0	12.0	1460	≤200	1140	≤1200	4,5	60
				24.0	1460	≤150	1170	≤900	5,4	60
CX.30GBE.14	14	30.0	6.0~24.0	12.0	521	≤200	430	≤1200	11	90
				24.0	521	≤150	445	≤900	12	90
CX.30GBE.19	19	30.0	6.0~24.0	12.0	384	≤200	310	≤1200	15	90
				24.0	384	≤150	320	≤900	17	90
CX.30GBE.27	27	30.0	65.0~24.0	12.0	270	≤200	221	≤1200	21	120
				24.0	270	≤150	229	≤900	24	120
CX.30GBE.35	35	30.0	6.0~24.0	12.0	208	≤200	170	≤1200	27	120
				24.0	208	≤150	176	≤900	31	120
CX.30GBE.51	51	36.4	6.0~24.0	12.0	143	≤200	117	≤1200	34	180
				24.0	143	≤150	121	≤900	40	180
CX.30GBE.71	71	36.4	6.0~24.0	12.0	102	≤200	83	≤1200	47	180
				24.0	102	≤150	87	≤900	55	180
CX.30GBE.100	100	36.4	6.0~24.0	12.0	73	≤200	60	≤1200	66	240
				24.0	73	≤150	62	≤900	78	240
CX.30GBE.139	139	36.4	6.0~24.0	12.0	52	≤200	45	≤1200	80	240
				24.0	52	≤150	46	≤900	80	240
CX.30GBE.189	189	42.4	6.0~24.0	12.0	38	≤200	32	≤1200	100	300
				24.0	38	≤150	34	≤900	100	300
CX.30GBE.264	264	42.4	6.0~24.0	12.0	27	≤200	25	≤1200	100	300
				24.0	27	≤150	26	≤900	100	300
CX.30GBE.516	516	42.4	6.0~24.0	12.0	14	≤200	13	≤1200	100	300
				24.0	14	≤150	13,5	≤900	100	300
CX.30GBE.721	721	42.4	6.0~24.0	12.0	10	≤200	9,6	≤1200	100	300
				24.0	10	≤150	9,8	≤900	100	300
CX.30GBE.939	939	42.4	6.0~24.0	12.0	8	≤200	7,3	≤1200	100	300
				24.0	8	≤150	7,3	≤900	100	300

General Tolerances ± 15%

do not apply a higher load to the maximum shown torque

General Information

- Direction of rotation according to polarity
- Operation relative humidity 20%~85% RH
- Radial load ≤ 3.0Kg (10mm from the flange)
- Backlash, at no load ≤ 2.5°
- Possibility to deliver the geared motors with hall sensor magnetic encoder
- Working temperature: -10°C ~ +60°C
- Gearbox with sleeve bearing
- Shaft axial load ≤ 2.5Kg
- Shaft press fit force, max ≤ 10.0Kg

PLANETARY GEARED MOTORS Serie CX.35GBE

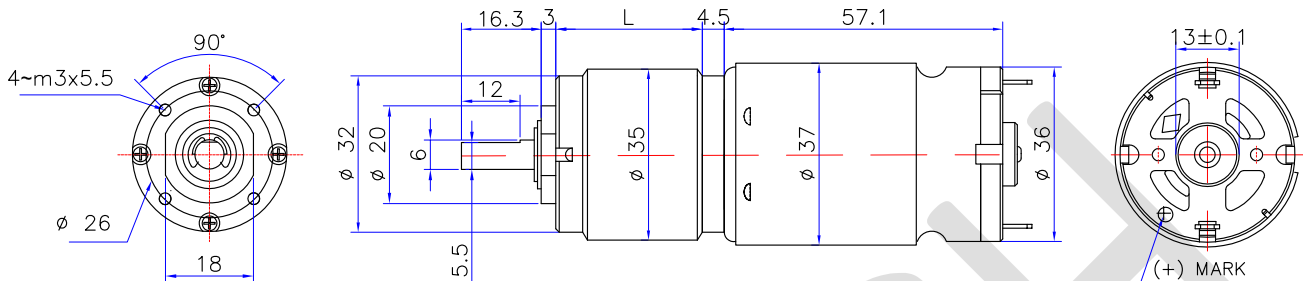

Electric performances

Article	Ratio To:1	L mm	Voltage (D.C.)		No Load		Rated Load			Max Torque N-cm
			Operating Range	Nominal Constant	Speed	Current	Speed	Current	Torque	
					rpm	mAmp	rpm	mAmp	N-cm	
CX.35GBE.5	5	17.6	6.0~30.0	12.0	1158	≤450	950	≤1350	10	40
				24.0		≤350		990		
CX.35GBE.14	14	24.0	6.0~30.0	12.0	437	≤450	359	≤1950	24	60
				24.0		≤350		375		
CX.35GBE.19	19	24.0	6.0~30.0	12.0	312	≤450	257	≤1850	33	80
				24.0		≤350		268		
CX.35GBE.27	27	24.0	6.0~30.0	12.0	223	≤450	183	≤1800	47	100
				24.0		≤350		192		
CX.35GBE.51	51	30.4	6.0~30.0	12.0	118	≤450	97	≤1800	76	120
				24.0		≤350		101		
CX.35GBE.71	71	30.4	6.0~30.0	12.0	84	≤450	70,5	≤1800	80	120
				24.0		≤350		74		
CX.35GBE.100	100	30.4	6.0~30.0	12.0	60	≤450	51	≤1300	100	200
				24.0		≤350		53		
CX.35GBE.139	139	30.4	6.0~30.0	12.0	43	≤450	38	≤1100	100	200
				24.0		≤350		39		
CX.35GBE.189	189	36.8	6.0~30.0	12.0	32	≤450	28	≤1000	120	200
				24.0		≤350		29		
CX.35GBE.264	264	36.8	6.0~30.0	12.0	23	≤450	21	≤800	120	200
				24.0		≤350		21.5		
CX.35GBE.516	516	36.8	6.0~30.0	12.0	11.5	≤450	11	≤600	120	200
				24.0		≤350		11		
CX.35GBE.721	721	36.8	6.0~30.0	12.0	8.3	≤450	8	≤500	120	200
				24.0		≤350		8		

General Tolerances ± 15%

do not apply a higher load to the maximum shown torque

General Information

- Direction of rotation according to polarity
- Operation relative humidity 20%~85% RH
- Radial load ≤ 3Kgf (10mm from the flange)
- Backlash, at no load ≤ 2,5°
- Possibility to deliver the geared motors with hall sensor magnetic encoder
- Working temperature: -10°C ~ +60°C
- Gearbox with sleeve bearing
- Shaft axial load ≤ 2.5Kgf
- Shaft press fit force, max ≤ 10Kgf

PLANETARY GEARED MOTORS Serie CX.42GBE

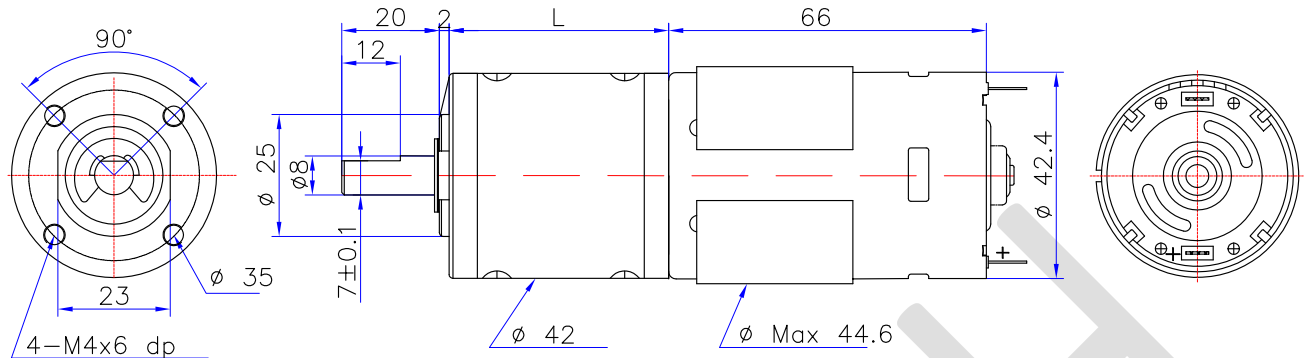

Electric performances

Article	Ratio To:1	L mm	Voltage (D.C.)		No Load		Rated Load			Max Torque N-cm
			Operating Range	Nominal Constant	Speed	Current	Speed	Current	Torque	
					rpm	mAmp	rpm	mAmp	N-cm	
CX.42GBE.14	14	39.2	12.0~24.0	12.0 24.0	500	≤1100 ≤650	405	≤4300 ≤2300	65	300
CX.42GBE.17	17	39.2	12.0~24.0	12.0 24.0	404	≤1100 ≤650	325	≤4300 ≤2300	75	300
CX.42GBE.24	24	39.2	12.0~24.0	12.0 24.0	290	≤1100 ≤650	240	≤4300 ≤2300	100	300
CX.42GBE.49	49	45.9	12.0~24.0	12.0 24.0	142	≤1200 ≤750	119	≤4300 ≤2300	180	600
CX.42GBE.61	61	45.9	12.0~24.0	12.0 24.0	115	≤1200 ≤750	96	≤4200 ≤2000	180	600
CX.42GBE.84	84	45.9	12.0~24.0	12.0 24.0	83	≤1300 ≤750	71	≤3300 ≤1600	180	600
CX.42GBE.104	104	45.9	12.0~24.0	12.0 24.0	67	≤1300 ≤750	60	≤2500 ≤1500	200	600
CX.42GBE.144	144	45.9	12.0~24.0	12.0 24.0	48	≤1300 ≤750	43	≤2500 ≤1500	200	600
CX.42GBE.212	212	52.6	12.0~24.0	12.0 24.0	33	≤1300 ≤900	30	≤2500 ≤1200	250	700
CX.42GBE.294	294	52.6	12.0~24.0	12.0 24.0	23,8	≤1300 ≤900	22	≤2000 ≤1000	250	700
CX.42GBE.504	504	52.6	12.0~24.0	12.0 24.0	13,8	≤1300 ≤900	12,5	≤2000 ≤1000	300	700
CX.42GBE.720	720	52.6	12.0~24.0	12.0 24.0	9,7	≤1300 ≤900	9,4	≤1600 ≤1000	300	800
CX.42GBE.1062	1062	59.3	12.0~24.0	12.0 24.0	6,6	≤1400 ≤900	6,4	≤1500 ≤1000	300	800
CX.42GBE.2500	2500	59.3	12.0~24.0	12.0 24.0	2,8	≤1400 ≤900	2,7	≤1500 ≤1000	300	900
CX.42GBE.3600	3600	59.3	12.0~24.0	12.0 24.0	1,9	≤1400 ≤900	1,8	≤1500 ≤1000	300	900

General Tolerances ± 15%

do not apply a higher load to the maximum shown torque

General Information

- Direction of rotation according to polarity
- Operation relative humidity 20%~85% RH
- Radial load ≤ 5Kgf (10mm from the flange)
- Backlash, at no load ≤ 3°
- Possibility to deliver the geared motors with hall sensor magnetic encoder
- Working temperature: -10°C ~ +60°C
- Gearbox with sleeve bearing
- Shaft axial load ≤ 3Kgf
- Shaft press fit force, max ≤ 15Kgf