

MASSIVE SP SERIES

for loads till 600 kg

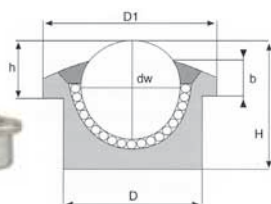

Massive carbon steel box obtained from machine full bar, for heavy load use and long product life. Support unit made of hardened carbon steel HCR 60-62, carbon steel balls I AISI 1010/1075 HCR 60-62. For SP-30 and SP-45 types in versions "A" and "B" chrome-steel balls AISI 52100 HCR 63+/-3 are used. Embodied discharge hole on the base of each type (except for SP-8). Internal dust-saving gasket standard on models SP-22/30/45 and on request only for types SP-15-25. Use temperature -30°C/+100°C.

| Type | Description | dw | D | Tol | D1 | h | Tol | H | b | Capacity | | Weight kg |
|----------|--|----|----|---------|------|------|-------|------|-----|----------|-----------|-----------|
| | | | | | | | | | | LOAD UP | LOAD DOWN | |
| SP 12 A | Steel box and balls | 12 | 22 | ± 0,030 | 27,3 | 7,5 | ± 0,2 | 16,8 | 4,5 | 30 | 12 | 0,035 |
| SP 15 A | | 15 | 24 | ± 0,065 | 31 | 9,5 | ± 0,2 | 21 | 5,5 | 60 | 24 | 0,055 |
| SP 22 A | | 22 | 36 | ± 0,080 | 45 | 9,8 | ± 0,2 | 30,5 | 6 | 180 | 72 | 0,185 |
| SP 30 A | | 30 | 45 | ± 0,080 | 55 | 13,8 | ± 0,3 | 36,8 | 8 | 350 | 140 | 0,365 |
| SP 45 A | | 45 | 62 | ± 0,095 | 75 | 19,0 | ± 0,4 | 53,5 | 10 | 600 | 240 | 0,990 |
| SP 12 B | Zinc-coated box and steel balls | 12 | 22 | ± 0,030 | 27,3 | 7,5 | ± 0,2 | 16,8 | 4,5 | 30 | 12 | 0,035 |
| SP 15 B | | 15 | 24 | ± 0,065 | 31 | 9,5 | ± 0,2 | 21 | 5,5 | 60 | 24 | 0,055 |
| SP 22 B | | 22 | 36 | ± 0,080 | 45 | 9,8 | ± 0,2 | 30,5 | 6 | 180 | 72 | 0,185 |
| SP 30 B | | 30 | 45 | ± 0,080 | 55 | 13,8 | ± 0,3 | 36,8 | 8 | 350 | 140 | 0,365 |
| SP 45 B | | 45 | 62 | ± 0,095 | 75 | 19,0 | ± 0,4 | 53,5 | 10 | 600 | 240 | 0,990 |
| SP 12 C | Zinc-coated box and stainless steel balls AISI 420 | 12 | 22 | ± 0,030 | 27,3 | 7,5 | ± 0,2 | 16,8 | 4,5 | 20 | 8 | 0,035 |
| SP 15 C | | 15 | 24 | ± 0,065 | 31 | 9,5 | ± 0,2 | 21 | 5,5 | 40 | 16 | 0,055 |
| SP 22 C | | 22 | 36 | ± 0,080 | 45 | 9,8 | ± 0,2 | 30,5 | 6 | 120 | 48 | 0,185 |
| SP 30 C | | 30 | 45 | ± 0,080 | 55 | 13,8 | ± 0,3 | 36,8 | 8 | 200 | 80 | 0,365 |
| SP 45 C | | 45 | 62 | ± 0,095 | 75 | 19,0 | ± 0,4 | 53,5 | 10 | 300 | 120 | 0,990 |
| SP 12 SS | Stainless steel box 303 and stainless steel balls AISI 420 | 12 | 22 | ± 0,030 | 27,3 | 7,5 | ± 0,2 | 16,8 | 4,5 | 20 | 8 | 0,035 |
| SP 15 SS | | 15 | 24 | ± 0,065 | 31 | 9,5 | ± 0,2 | 21 | 5,5 | 40 | 16 | 0,055 |
| SP 22 SS | | 22 | 36 | ± 0,080 | 45 | 9,8 | ± 0,2 | 30,5 | 6 | 120 | 48 | 0,185 |
| SP 30 SS | | 30 | 45 | ± 0,080 | 55 | 13,8 | ± 0,3 | 36,8 | 8 | 200 | 80 | 0,365 |
| SP 45 SS | | 45 | 62 | ± 0,095 | 75 | 19,0 | ± 0,4 | 53,5 | 10 | 300 | 120 | 0,990 |

MASSIVE SP SERIES

for loads till 600 kg

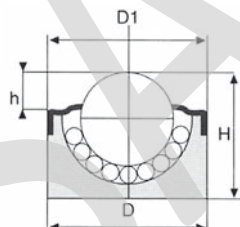

| Type | Description | dw | D | Tol | D1 | h | Tol | H | b | Capacity | | Weight kg |
|------------|--|----|----|---------|----|-----|-------|------|----|----------|-----------|-----------|
| | | | | | | | | | | LOAD UP | LOAD DOWN | |
| SP 8 A | Steel box and balls | 8 | 18 | ± 0,030 | 18 | 2,2 | ± 0,1 | 12 | 15 | 6 | 0,018 | |
| SP 12 A(2) | | 12 | 22 | ± 0,030 | 22 | 5,5 | ± 0,2 | 17,5 | 30 | 12 | 0,035 | |
| SP 8 B | Zinc-coated box and steel balls | 8 | 18 | ± 0,030 | 18 | 2,2 | ± 0,1 | 12 | 15 | 6 | 0,018 | |
| SP 12 B(2) | | 12 | 22 | ± 0,030 | 22 | 5,5 | ± 0,2 | 17,5 | 30 | 12 | 0,035 | |
| SP 8 C | Zinc-coated box and stainless steel balls AISI 420 steel | 8 | 18 | ± 0,030 | 18 | 2,2 | ± 0,1 | 12 | 10 | 4 | 0,018 | |
| SP 12 C(2) | | 12 | 22 | ± 0,030 | 22 | 5,5 | ± 0,2 | 17,5 | 20 | 8 | 0,035 | |
| SP 8 SS | Stainless steel box 303 and stainless steel balls AISI 420 | 8 | 18 | ± 0,030 | 18 | 2,2 | ± 0,1 | 12 | 10 | 4 | 0,018 | |
| SP 12 S(2) | | 12 | 22 | ± 0,030 | 22 | 5,5 | ± 0,2 | 17,5 | 20 | 8 | 0,035 | |

MASSIVE SP SERIES WITH PLASTIC BALL

for loads till 40 kg

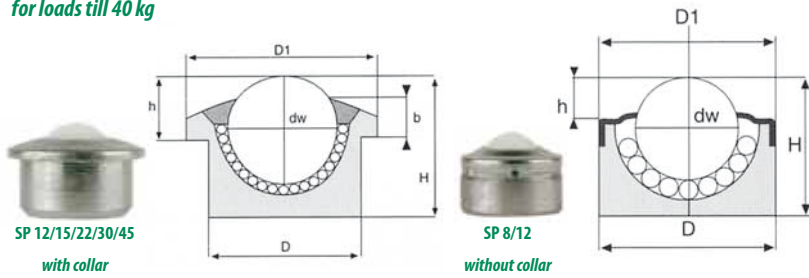

Higher diameter ball in POM-polyacetal (Delrin). Because of the lightness of the plastic ball, models SP-22/30/45 are not provided any internal dust-saving gasket to enable free running of the big ball. The gasket can be mounted on request for special applications. Exercise temperature: +60°C. This application is not suitable for use with upside down ball. Series discharge hole in all types (except for SP-8).

| Type | Description | dw | D | Tol | D1 | h | Tol | H | b | Capacity | Weight kg |
|----------------|--|----|----|---------|------|------|-------|------|-----|----------|-----------|
| SP 8 B-D | Zinc-coated box, big plastic and small steel balls | 8 | 18 | ± 0,03 | 18 | 2,2 | ± 0,2 | 12 | - | 3 | 0,015 |
| SP 12 B-D | | 12 | 22 | ± 0,03 | 27,3 | 7,5 | ± 0,2 | 16,8 | 4,5 | 6 | 0,028 |
| SP 12 B-D(2) | | 12 | 22 | ± 0,03 | 22 | 5,5 | ± 0,2 | 17,5 | - | 6 | 0,025 |
| SP 15 B-D | | 15 | 24 | ± 0,065 | 31 | 9,5 | ± 0,2 | 21 | 5,5 | 9 | 0,030 |
| SP 22 B-D | | 22 | 36 | ± 0,08 | 45 | 9,8 | ± 0,2 | 30,5 | 6 | 15 | 0,100 |
| SP 30 B-D | | 30 | 45 | ± 0,08 | 55 | 13,8 | ± 0,3 | 36,8 | 8 | 25 | 0,200 |
| SP 45 B-D | | 45 | 55 | ± 0,095 | 75 | 19 | ± 0,4 | 53,5 | 10 | 40 | 0,450 |
| SP 8 C-D | Zinc-coated box, big plastic ball and small stainless steel balls AISI 420 | 8 | 18 | ± 0,03 | 18 | 2,2 | ± 0,2 | 12 | - | 3 | 0,015 |
| SP 12 C-D | | 12 | 22 | ± 0,03 | 27,3 | 7,5 | ± 0,2 | 16,8 | 4,5 | 6 | 0,028 |
| SP 12 C-D(2) | | 12 | 22 | ± 0,03 | 22 | 5,5 | ± 0,2 | 17,5 | - | 6 | 0,025 |
| SP 15 C-D | | 15 | 24 | ± 0,065 | 31 | 9,5 | ± 0,2 | 21 | 5,5 | 9 | 0,030 |
| SP 22 C-D | | 22 | 36 | ± 0,08 | 45 | 9,8 | ± 0,2 | 30,5 | 6 | 15 | 0,100 |
| SP 30 C-D | | 30 | 45 | ± 0,08 | 55 | 13,8 | ± 0,3 | 36,8 | 8 | 25 | 0,200 |
| SP 45 C-D | | 45 | 55 | ± 0,095 | 75 | 19 | ± 0,4 | 53,5 | 10 | 40 | 0,450 |
| SP 8 SS-CD | Stainless steel box 303, big plastic ball and small stainless steel balls AISI 420 | 8 | 18 | ± 0,03 | 18 | 2,2 | ± 0,2 | 12 | - | 3 | 0,015 |
| SP 12 SS-CD | | 12 | 22 | ± 0,03 | 27,3 | 7,5 | ± 0,2 | 16,8 | 4,5 | 6 | 0,028 |
| SP 12 SS-CD(2) | | 12 | 22 | ± 0,03 | 22 | 5,5 | ± 0,2 | 17,5 | - | 6 | 0,025 |
| SP 15 SS-CD | | 15 | 24 | ± 0,065 | 31 | 9,5 | ± 0,2 | 21 | 5,5 | 9 | 0,030 |
| SP 22 SS-CD | | 22 | 36 | ± 0,08 | 45 | 9,8 | ± 0,2 | 30,5 | 6 | 15 | 0,100 |
| SP 30 SS-CD | | 30 | 45 | ± 0,08 | 55 | 13,8 | ± 0,3 | 36,8 | 8 | 25 | 0,200 |
| SP 45 SS-CD | | 45 | 55 | ± 0,095 | 75 | 19 | ± 0,4 | 53,5 | 10 | 40 | 0,450 |

MASSIVE SP SERIES

for loads till 600 kg

Ø 1" ball

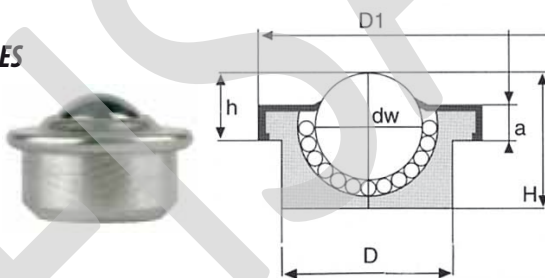

Carbon steel massive box obtained from machine full bar, with pressed sheet cover and discharge hole on the base. Dust-saving gasket only on request.

| Type | Description | dw | D | D1 | h | H | a | Capacity | Weight kg |
|----------|---|-----------|-----------|----|----------|----|---|----------|-----------|
| SP 25 A | Steel box and balls | 1" = 25,4 | 38 ± 0,08 | 45 | 14 ± 0,2 | 31 | 5 | 200 / 80 | 0,190 |
| SP 25 B | Zinc-coated box and steel balls | 1" = 25,4 | 38 ± 0,08 | 45 | 14 ± 0,2 | 31 | 5 | 200 / 80 | 0,190 |
| SP 25 C | Zinc-coated box and stainless steel balls AISI 420 | 1" = 25,4 | 38 ± 0,08 | 45 | 14 ± 0,2 | 31 | 5 | 110 / 44 | 0,190 |
| SP 25 D | Zinc-coated box, big plastic ball and small steel balls | 1" = 25,4 | 38 ± 0,08 | 45 | 14 ± 0,2 | 31 | 5 | 18 / 7 | 0,110 |
| SP 25 SS | Stainless steel box 303, and stainless steel balls AISI 420 | 1" = 25,4 | 38 ± 0,08 | 45 | 14 ± 0,2 | 31 | 5 | 110 / 44 | 0,190 |

**MASSIVE SP-CX SERIES
AIRPORT AND
HARBOUR USE**

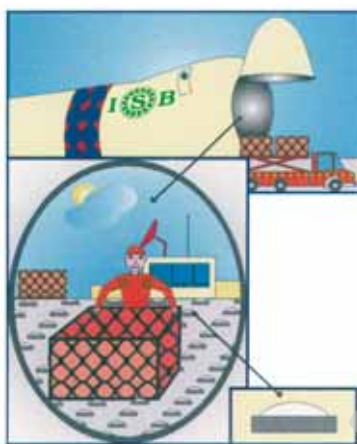
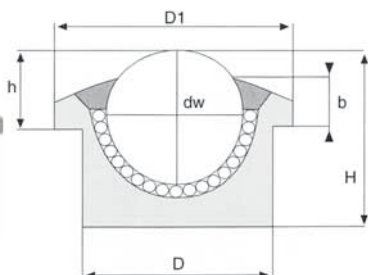

Massive carbon steel box obtained from machine full bar, with AISI 420 stainless steel internal hemispheric vacuum hardened cap, HCR 60 hardness, with dust-saving gasket and discharge hole on the base. This version is particularly suitable for granting a long life and good resistance to corrosion in extreme use conditions, in outdoor environments with rain, snow, ice and dust. Exercise temperature between -50°C/+100°C. On request it can be supplied with stainless steel balls AISI 440C-304-316.

| Type | Description | dw | D | Tol | D1 | h | Tol | H | b | Capacity | | Weight kg |
|--------------------|---|----|----|---------|----|------|-------|------|----|----------|-----------|-----------|
| | | | | | | | | | | LOAD UP | LOAD DOWN | |
| SP 22 CX | Zinc-coated box stainless steel internal cap and balls AISI 420 | 22 | 36 | ± 0,08 | 45 | 9,8 | ± 0,2 | 30,5 | 6 | 120 | 48 | 0,185 |
| SP 30 CX | | 30 | 45 | ± 0,08 | 55 | 13,8 | ± 0,3 | 36,8 | 8 | 200 | 80 | 0,365 |
| SP 45 CX | | 45 | 55 | ± 0,095 | 75 | 19 | ± 0,4 | 53,5 | 10 | 300 | 120 | 0,990 |
| SP 22 CX-SS | Stainless steel box 303 stainless steel internal cap and balls AISI 420 | 22 | 36 | ± 0,08 | 45 | 9,8 | ± 0,2 | 30,5 | 6 | 120 | 48 | 0,185 |
| SP 30 CX-SS | | 30 | 45 | ± 0,08 | 55 | 13,8 | ± 0,3 | 36,8 | 8 | 200 | 80 | 0,365 |
| SP 45 CX-SS | | 45 | 55 | ± 0,095 | 75 | 19 | ± 0,4 | 53,5 | 10 | 300 | 120 | 0,990 |

SUPER MASSIVE SP SERIES

for loads till 3.000 kg



SP 60

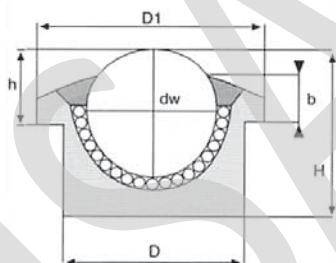

Suitable for high stresses, extremely heavy loads and long life. Massive steel UN 18NiCrMo5 (=UNI 7846-78/AFNOR 18NCD6/B.S.EN353) carbonitrided (CM7 case hardening + tempera of hardness HRC60, thickness 0,6/0,8mm), box, with internal dust-saving gasket and discharge hole on the base. Chrome steel AISI balls 52100 100Cr6 G 100 ISO 3290 with HRC 60/62 hardness in versions "A" and "B". On request chrome steel balls G10/G16/G20 ISO 3290.

| Type | Description | dw | D | Tol | D1 | h | Tol | H | b | Capacity | | Weight kg |
|----------------|--|----|-----|---------|-----|------|-------|------|------|----------|-----------|-----------|
| | | | | | | | | | | LOAD UP | LOAD DOWN | |
| SP 60 A | Steel box and balls | 60 | 100 | ± 0,010 | 117 | 29,5 | ± 0,4 | 77,5 | 14,5 | 1500 | 600 | 3,5 |
| SP 60 B | Zinc-coated box and steel balls | 60 | 100 | ± 0,010 | 117 | 29,5 | ± 0,4 | 77,5 | 14,5 | 1500 | 600 | 3,5 |
| SP 60 C | Zinc-coated box and stainless steel balls AISI 420 | 60 | 100 | ± 0,010 | 117 | 29,5 | ± 0,4 | 77,5 | 14,5 | 900 | 360 | 3,5 |

SUPER MASSIVE SP SERIES

for load till 3000 kg



SP 76/SP 90

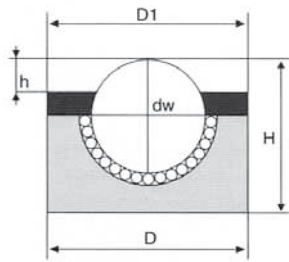

| Type | Description | dw | D | Tol | h | Tol | H | Capacity | | Weight kg |
|---------|--|----|-----|--------|----|--------|-----|----------|-----------|-----------|
| | | | | | | | | LOAD UP | LOAD DOWN | |
| SP 76 A | Steelbox and balls | 76 | 130 | ± 0,08 | 23 | ± 0,05 | 103 | 2500 | 1000 | 8,6 |
| SP 76 B | Zinc-coated box and steel balls | 76 | 130 | ± 0,08 | 23 | ± 0,05 | 103 | 2500 | 1000 | 8,6 |
| SP 76 C | Zinc-coated and stainless steel balls AISI 420 | 76 | 130 | ± 0,08 | 23 | ± 0,05 | 103 | 1500 | 600 | 8,6 |
| SP 90 A | Steelbox and balls | 90 | 145 | ± 0,08 | 23 | ± 0,05 | 115 | 3000 | 1200 | 11 |
| SP 90 B | Zinc-coated box and steel balls | 90 | 145 | ± 0,08 | 23 | ± 0,05 | 115 | 3000 | 1200 | 11 |
| SP 90 C | Zinc-coated box and stainless steel balls AISI 420 | 90 | 145 | ± 0,08 | 23 | ± 0,05 | 115 | 1800 | 720 | 11 |

MASSIVE SP-FL SERIES WITH THREADED STEM

for loads till 60 kg



SP 15



SP 12

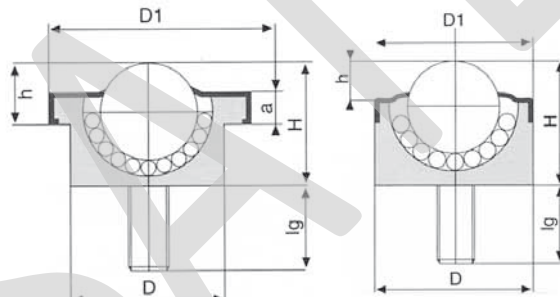

Massive carbon steel box with threaded stem obtained from machine full bar, pressed sheet cap. Threaded stem size: diameter 6/8/10mm and length 10/15/20/25/30mm. Dust-saving gasket not included.

| Type | Description | dw | D ± 0,06 | D1 | h ± 0,06 | H | a | Capacity | | Weight kg |
|----------------|--|----|----------|----|----------|----|---|----------|-----------|-----------|
| | | | | | | | | LOAD UP | LOAD DOWN | |
| SP 12 A-FL | Steelbox and balls | 12 | 22 | 22 | 6 | 17 | - | 30 | 12 | 0,045 |
| SP 15 A-FL | | 15 | 24 | 31 | 10 | 21 | 5 | 60 | 24 | 0,070 |
| SP 12 B-FL | Zinc-coated box and steel balls | 12 | 22 | 22 | 6 | 17 | - | 30 | 12 | 0,045 |
| SP 15 B-FL | | 15 | 24 | 31 | 10 | 21 | 5 | 60 | 24 | 0,070 |
| SP 12 C-FL | Zinc-coated box and stainless steel balls AISI 420 | 12 | 22 | 22 | 6 | 17 | - | 12 | 6 | 0,045 |
| SP 15 C-FL | | 15 | 24 | 31 | 10 | 21 | 5 | 25 | 10 | 0,070 |
| SP 12 D-FL | Zinc coated box, big plastic ball and small stainless steel balls | 12 | 22 | 22 | 6 | 17 | - | 6 | - | 0,035 |
| SP 15 D-FL | | 15 | 24 | 31 | 10 | 21 | 5 | 8 | - | 0,040 |
| SP 12 SS-FL | Stainless steel box 303 and stainless steel balls AISI 420 | 12 | 22 | 22 | 6 | 17 | - | 15 | 6 | 0,045 |
| SP 15 SS-FL | | 15 | 24 | 31 | 10 | 21 | 5 | 25 | 10 | 0,070 |
| SP 12 SS-CD-FL | Stainless steel box 303, big plastic ball and small stainless steel balls AISI 420 | 12 | 22 | 22 | 6 | 17 | - | 6 | - | 0,035 |
| SP 15 SS-CD-FL | | 15 | 24 | 31 | 10 | 21 | 5 | 8 | - | 0,040 |

**MASSIVE AF SERIES
WITH INTERNAL SPRINGING ELEMENTS**

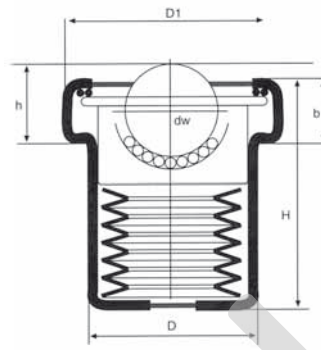

| Type | Description | dw | D | D1 | h | Tol | H | b | Load compress | Capacity | Weight kg |
|---|--|----------------|--------------------|----------------|-------------------|-------------------------------|-------------------|--------------------|---------------|-----------------|----------------------|
| SP 22 AF SP 30 AF SP 45 AF | Steel box and balls | 22 30 45 | 39 48,5 66,5 | 50 62 85 | 18,5 245 36 | ± 0,100 ± 0,125 ± 0,150 | 58 10 100,5 | 14 17,5 25,5 | 7 13 22 | 80 70 217 | 0,37 0,62 1,65 |
| SP 22 BF SP 30 BF SP 45 BF | Zinc-coated box and steel balls | 22 30 45 | 39 48,5 66,5 | 50 62 85 | 18,5 245 36 | ± 0,100 ± 0,125 ± 0,150 | 58 10 100,5 | 14 17,5 25,5 | 7 13 22 | 80 70 217 | 0,37 0,62 1,65 |
| SP 22 CF SP 30 CF SP 45 CF | Zinc-coated box and stainless steel balls AISI 420 | 22 30 45 | 39 48,5 66,5 | 50 62 85 | 18,5 245 36 | ± 0,100 ± 0,125 ± 0,150 | 58 10 100,5 | 14 17,5 25,5 | 7 13 22 | 80 70 217 | 0,37 0,62 1,65 |

**SP SERIES
WITH PLASTIC BOX**

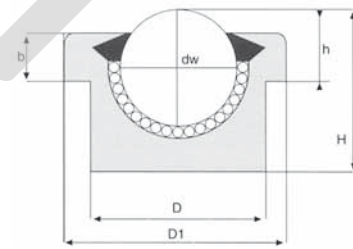

"ABS" box with tempered steel internal hemispheric cap, ball diameter 1"=25,4 mm.

| Type | Description | dw | D | D1 | h | Tol | H | b | Capacity | | Weight kg |
|--------------------|--|--------------|---------------|------|------|-------|---------------|-----|----------|-----------|-----------|
| | | | | | | | | | LOAD UP | LOAD DOWN | |
| SP 25 PA | Plastic box and steel balls | 1" = 25,4 | 37,5 ± 0,5 | 45,5 | 14,7 | ± 0,3 | 32,5 ± 0,5 | 8,3 | 40 | 16 | 0,140 |
| SP 25 P-C | Plastic box and stainless steel balls AISI 420 | 1" = 25,4 | 37,5 ± 0,5 | 45,5 | 14,7 | ± 0,3 | 32,5 ± 0,5 | 8,3 | 30 | 12 | 0,140 |
| SP 25 P-C-D | Plastic box and big ball, stainless steel balls AISI 420 | 1" = 25,4 | 37,5 ± 0,5 | 45,5 | 14,7 | ± 0,3 | 32,5 ± 0,5 | 8,3 | 10 | - | 0,080 |

SPS SERIES PRESSED SHEET

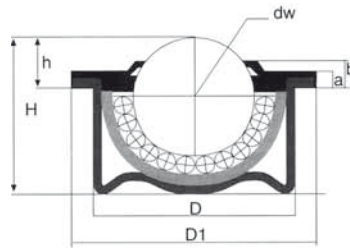

Zinc-coated pressed sheet box with tempered steel internal cap, internal dust-saving gasket (only in SPS-22 and SPS-30 models). Exercise temperature -30°C/+100°C.

| Type | Description | dw | D | Tol | D1 | h | Tol | H | a | b | Capacity | | Weight kg |
|------------------|--|----|----|---------|----|------|-------|------|-----|-----|----------|-----------|-----------|
| | | | | | | | | | | | LOAD UP | LOAD DOWN | |
| SPS 15 B | Zinc-coated box and steel balls | 15 | 24 | ± 0,065 | 31 | 9,5 | ± 0,2 | 20,7 | 2,8 | 6,3 | 50 | 20 | 0,038 |
| SPS 22 B | | 22 | 36 | ± 0,080 | 45 | 9,8 | ± 0,2 | 29,5 | 2,8 | 5,5 | 130 | 52 | 0,132 |
| SPS 30 B | | 30 | 45 | ± 0,080 | 55 | 13,8 | ± 0,3 | 37 | 4 | 8,3 | 250 | 100 | 0,265 |
| SPS 15 C | Zinc coated box and stainless steel balls AISI 420 | 15 | 24 | ± 0,065 | 31 | 9,5 | ± 0,2 | 20,7 | 2,8 | 6,3 | 37 | 15 | 0,038 |
| SPS 22 C | | 22 | 36 | ± 0,080 | 45 | 9,8 | ± 0,2 | 29,5 | 2,8 | 5,5 | 97 | 39 | 0,132 |
| SPS 30 C | | 30 | 45 | ± 0,080 | 55 | 13,8 | ± 0,3 | 37 | 4 | 8,3 | 190 | 76 | 0,265 |
| SPS 15 SS | Stainless steel box 304, stainless steel internal cap and balls AISI 420 | 15 | 24 | ± 0,065 | 31 | 9,5 | ± 0,2 | 20,7 | 2,8 | 6,3 | 37 | 15 | 0,038 |
| SPS 22 SS | | 22 | 36 | ± 0,080 | 45 | 9,8 | ± 0,2 | 29,5 | 2,8 | 5,5 | 97 | 39 | 0,132 |
| SPS 30 SS | | 30 | 45 | ± 0,080 | 55 | 13,8 | ± 0,3 | 37 | 4 | 8,3 | 190 | 76 | 0,265 |

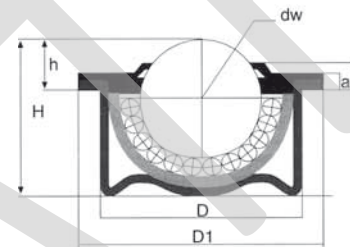

With big ball in POM-polyacetal (Delrin) without dust-saving gasket, not suitable for upside down ball applications.

| Type | Description | dw | D | Tol | D1 | h | Tol | H | a | b | Capacity | Weight kg |
|--------------------|--|----|----|---------|----|------|-------|------|-----|-----|----------|-----------|
| | | | | | | | | | | | LOAD UP | |
| SPS 15 B-D | Zinc-coated box, big plastic ball and small steel balls | 15 | 24 | ± 0,065 | 31 | 9,5 | ± 0,2 | 20,7 | 2,8 | 6,3 | 7 | 0,024 |
| SPS 22 B-D | | 22 | 36 | ± 0,080 | 45 | 9,8 | ± 0,2 | 29,5 | 2,8 | 5,5 | 10 | 0,093 |
| SPS 30 B-D | | 30 | 45 | ± 0,080 | 55 | 13,8 | ± 0,3 | 37 | 4 | 8,3 | 15 | 0,168 |
| SPS 15 C-D | Zinc-coated box, big plastic ball and small stainless steel balls AISI 420 | 15 | 24 | ± 0,065 | 31 | 9,5 | ± 0,2 | 20,7 | 2,8 | 6,3 | 7 | 0,024 |
| SPS 22 C-D | | 22 | 36 | ± 0,080 | 45 | 9,8 | ± 0,2 | 29,5 | 2,8 | 5,5 | 10 | 0,093 |
| SPS 30 C-D | | 30 | 45 | ± 0,080 | 55 | 13,8 | ± 0,3 | 37 | 4 | 8,3 | 15 | 0,168 |
| SPS 15 SSCD | Stainless steel box 304, stainless steel cap and balls AISI 420 | 15 | 24 | ± 0,065 | 31 | 9,5 | ± 0,2 | 20,7 | 2,8 | 6,3 | 7 | 0,024 |
| SPS 22 SSCD | | 22 | 36 | ± 0,080 | 45 | 9,8 | ± 0,2 | 29,5 | 2,8 | 5,5 | 10 | 0,093 |
| SPS 30 SSCD | | 30 | 45 | ± 0,080 | 55 | 13,8 | ± 0,3 | 37 | 4 | 8,3 | 15 | 0,168 |

FIXING METHODS

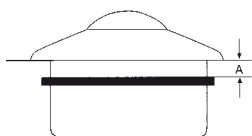

DIN 471 Retaining ring
(only for types with massive SP series box) please communicate the "A" quote dimension.

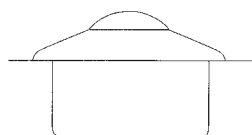

Pressure

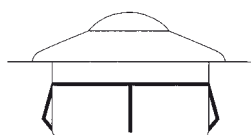
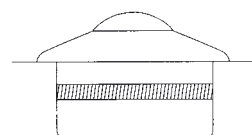

With fixing clip

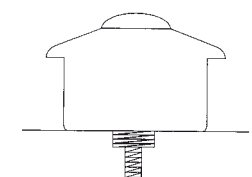

With threaded nut

PRODUCTION PROGRAM

| Material | Diameters | Degrees of accuracy ISO 3290 |
|---|-----------------|--|
| CHROME STEEL AISI 52100 | 0,2 mm - 250 mm | G3, G5, G10, G16, G20, G28, G40, G100, G200, G500, G1000 |
| CARBON STEEL AISI 1060-1075-1085 | 1,5 mm - 33 mm | G40, G100, G200 |
| CARBON STEEL - AISI 1010-1015 | 1,5 mm - 50 mm | G100, G200, G500, G1000 |
| STAINLESS STEEL AISI 420B, 420C, 304, 304L, 316, 316L | 0,2 mm - 150 mm | G3, G5, G10, G16, G20, G28, G40, G100, G200, G500, G1000 |
| TUNGSTEN CARBIDE | 0,2 mm - 150 mm | G10, G20, G40, G200 |
| CERAMIC Al_2O_3 E Si_3N_4 | 0,5 mm - 50 mm | G5, G10, G20, G40, G200 |
| SODA LIME GLASS | 1 mm - 150 mm | G200 |
| BORO-SILICATE BLACK GLASS | 1 mm - 50 mm | G10, G20, G40, G200 |
| PLASTICS: NYLON, DELRIN POLYPROPYLENE, POLYTHENE, TEFLON, POLYSTYRENE, PVC, TORLON, ABS | 1 mm - 60 mm | G I, G II, G III |
| RUBBER: EPDM, VITON, SILICONE, POLYURETHANE, NBR | 2 mm - 50 mm | G II, G III |
| ALLOYS: MONEL-K, HASTELLOY, MSO, TANTALUM, COBALT, BRONZE, BRASS, TITANIUM, ALUMINUM, INCONEL, CARPENTER 20 CB3 | 2 mm - 50 mm | G100, G200 |