

art.SAR/FD..

ANTI-TIP BRACKET FOR UNALIGNED ATTACHMENT

These brackets offer a more complete solution when compared to the mod. SAR/FR by offering a broader field of adjustment of the machine fitted with Stabilisers and **prevent possible tipping**; tipping that could be caused by it's structure (for example machinery that is very tall and narrow) or by external factors such as accidental bumping or lateral forces(such as wind etc).

The main characteristic is that of being able to easily adapt to countless applications because it comprises two distinct parts **that can work unaligned with each other**. One part is fitted to the machine/structure and the other to the floor and between them is a special tensioning system with adjustable threaded bar and rotating pins. The bracket is fixed to the machine by connecting bolts, whilst fitting to the floor is achieved by using steel expanding screw anchors. All of the bracket parts are made in iron (Fe) and nitrided by us to provide better wear and resistance to weathering and oxidisation. The bolts and expanding screw anchors are in zinc plated steel and we supply them as accessories for the bracket itself.

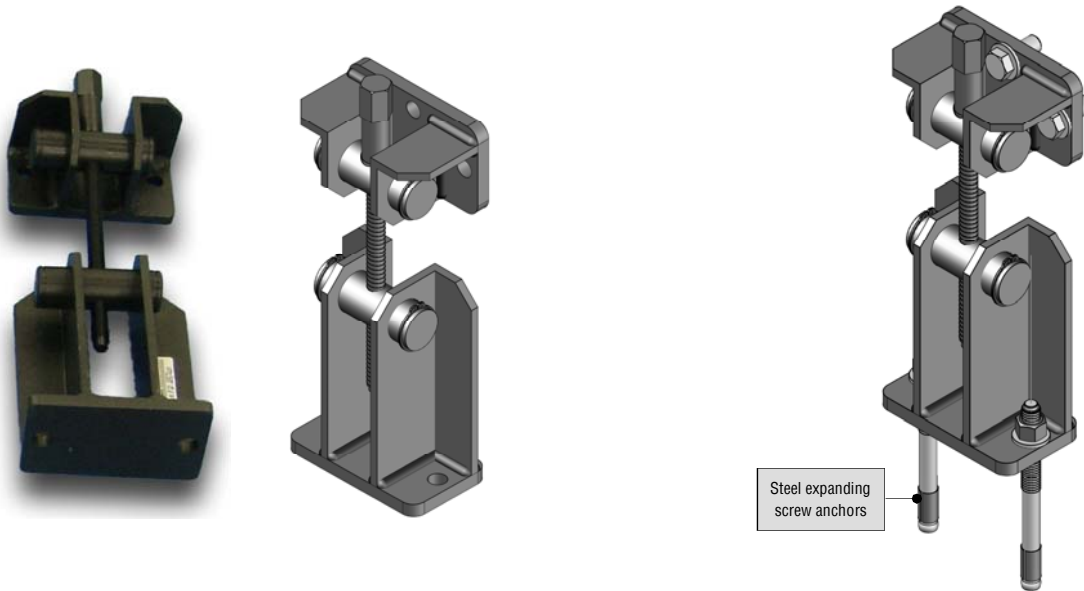
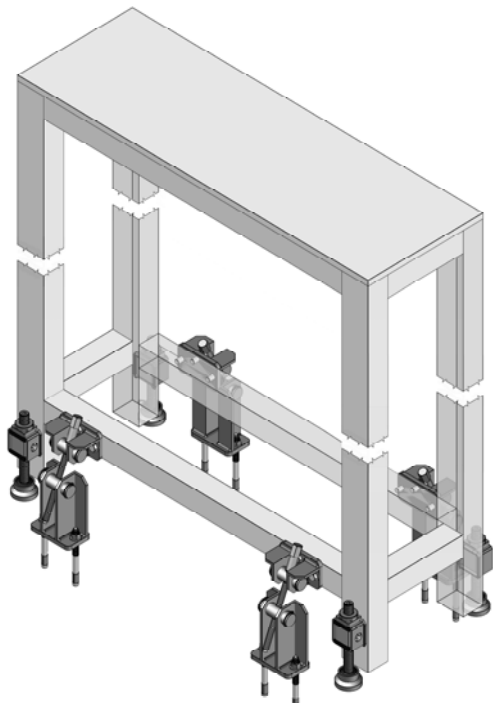
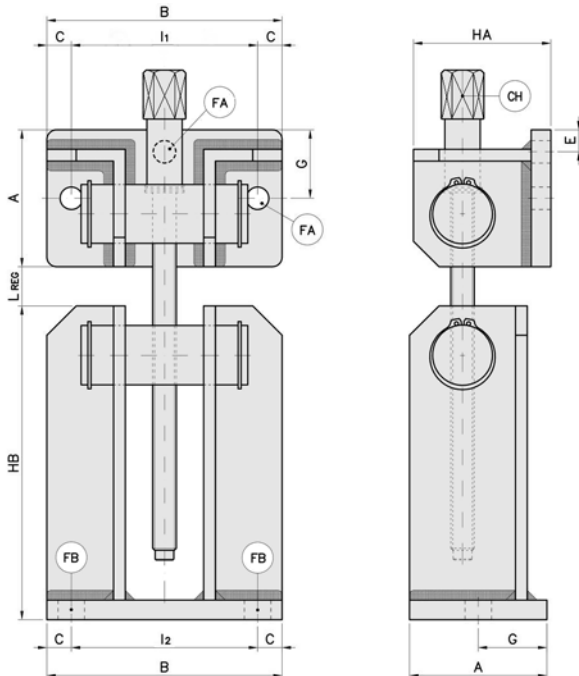

Diagram of unaligned Anti-Tip Bracket.

Example of application using unaligned Anti-Tip brackets.



Symbols:

I₁ = distance between the two holes for fitting the top Bracket to the machine + third hole in centre with distance "E" from the top. We recommend making all the holes as the machine is positioned on the floor.

I₂ = distance between the two holes for fitting the lower bracket to the floor using expanding screw anchors.

Mod.	CODE	ARTICLE	A	B	HA	HB	FB	STEEL EXPAN-DING SCREW ANCHORS	I ₁	C	G	FA	I ₂	E	CH	L _{REG} MAX	WEIGHT Kg
20/40	2AC022040	SAR/FD20/40	70	120	70	160	Ø13,5	M12x150	95	12,5	35	Ø11,5	95	11	19	100	4,140
45/60	2AC024560	SAR/FD45/60	90	150	92	212	18	M16x190	115	17,5	55	Ø15	115	15	24	140	7,510